

## Part List

①	×1	Seal Strip
②	×1	Replacement Clamp

### Warning:

1. Tonneau cover must be completely secured in the closed position or opened position while driving. DO NOT DRIVE with cover in partially opened position.
2. Clean the debris before folding the tonneau cover.
3. Professional installation would be highly recommended.
4. Period check to ensure all clamps remain secure and tight.
5. Remove the tonneau cover before towing the truck from rear.
6. Do not drive without safety clamps
7. Must secure all clamps, especially the SAFETY CLAMPS for fastening and safety purposes. Any damages, losses, or injuries resulting from the non-use or misuse of clamps will not be covered by us.

### Step 1:

1. Clean the bulkhead and bedrail before installation.
2. Stick the seal strip onto the bulkhead.

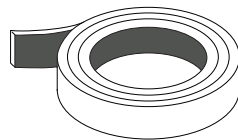
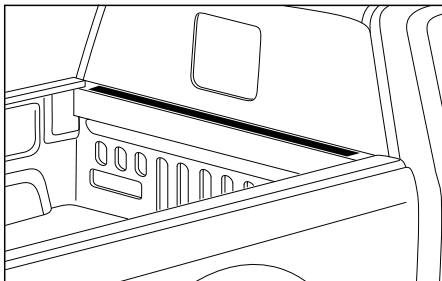

### Step 2:

1. Place cover assembly on front truck bed rail against the cab.
2. Release safety buckles.

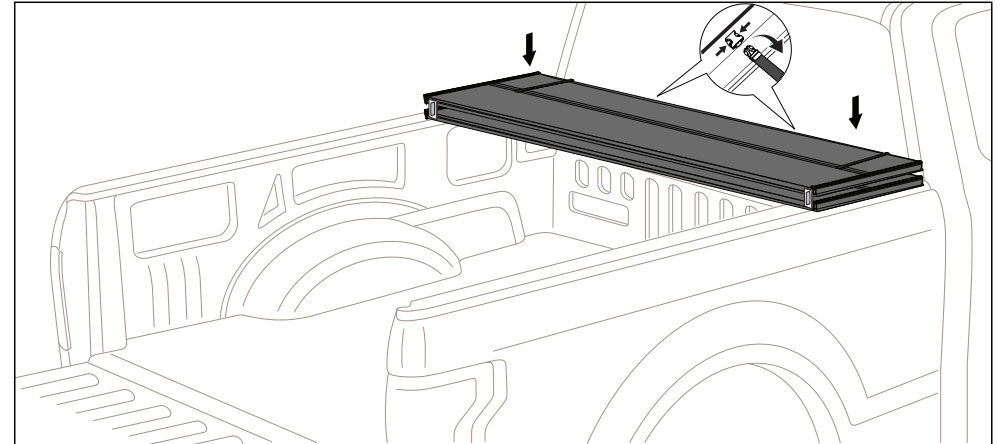

### Step 3:

1. Fully unfold the cover towards rear.
2. Ensure the cover aligns on truck bed.

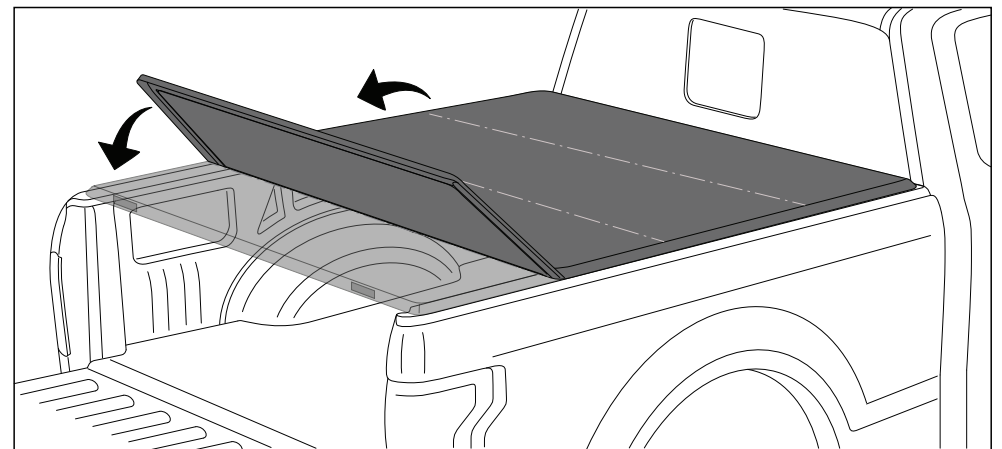

## Step 4:

Carefully refold the cover without moving position on the truck bed.

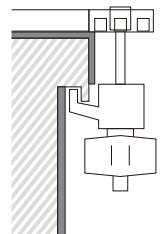
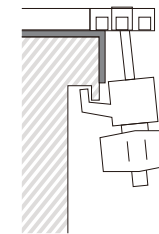
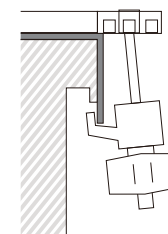
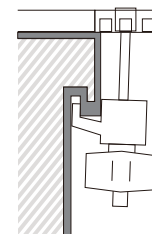
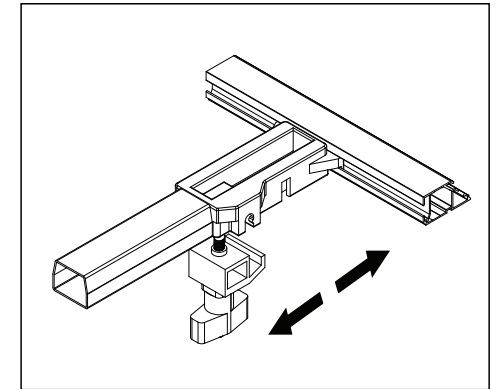
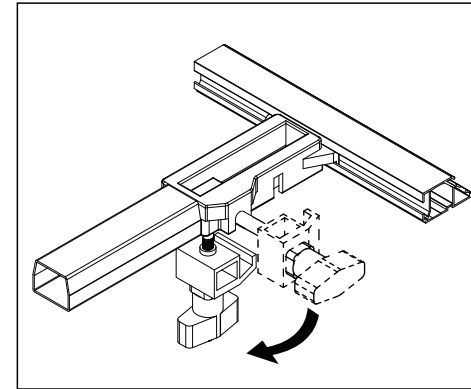
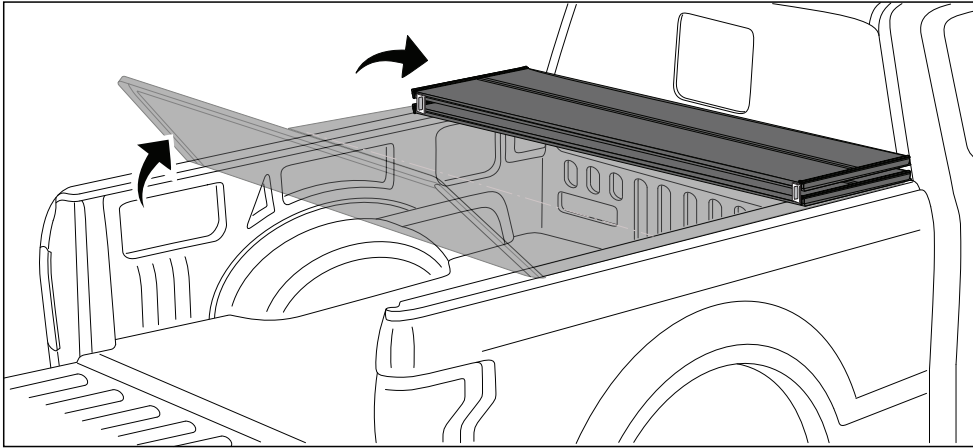

The clamps may not precisely vertical.

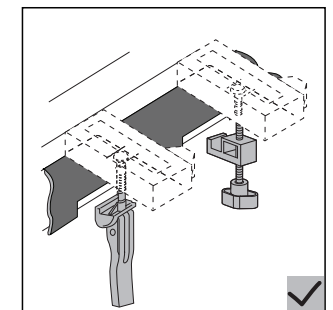
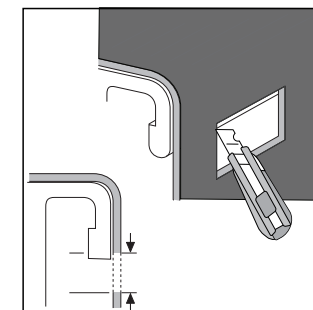
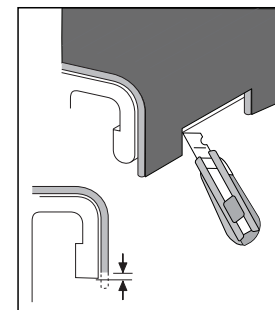

## Step 5:

Secure the front clamps.

1. Slide front clamp to proper position.
2. Pull down the front clamp to vertical.
3. Hook the J-shaped clamp under the metal bed rail lip and tighten the knob.

Note:  
Cutting the bedliner is necessary.

## Step 6:

1. Loosen the safety clamp and attach to the bed rail lip.
2. Hand tighten the knob clockwise. DO NOT use wrench or overtighten.

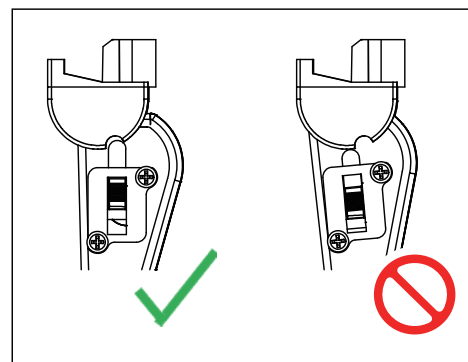
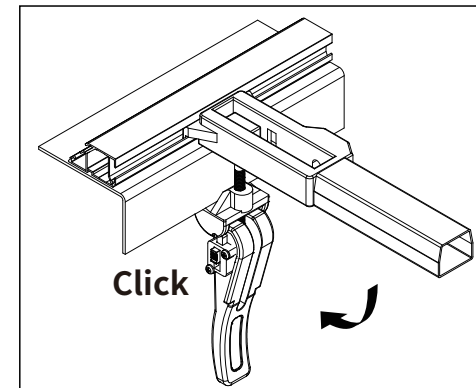
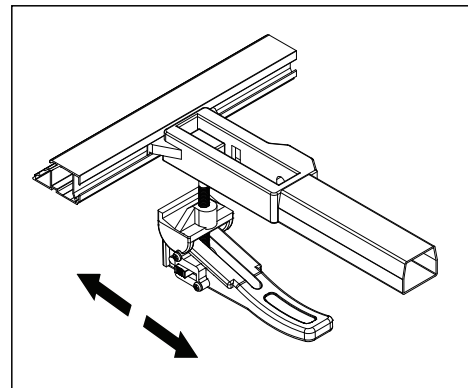
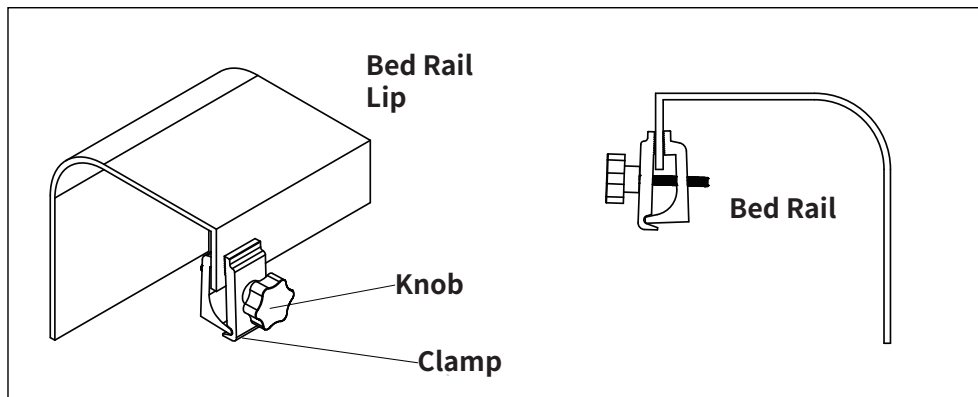

## Step 7:

Carefully unfold the cover and secure the rear clamps.

1. Slide clamp to proper position.
2. Pull down the clamp.
3. Turn the clamp handle to adjust the clamp to proper length.
4. Hook the J-shaped clamp under the metal bed rail lip and push the clamp handle to vertical position with a click sound.

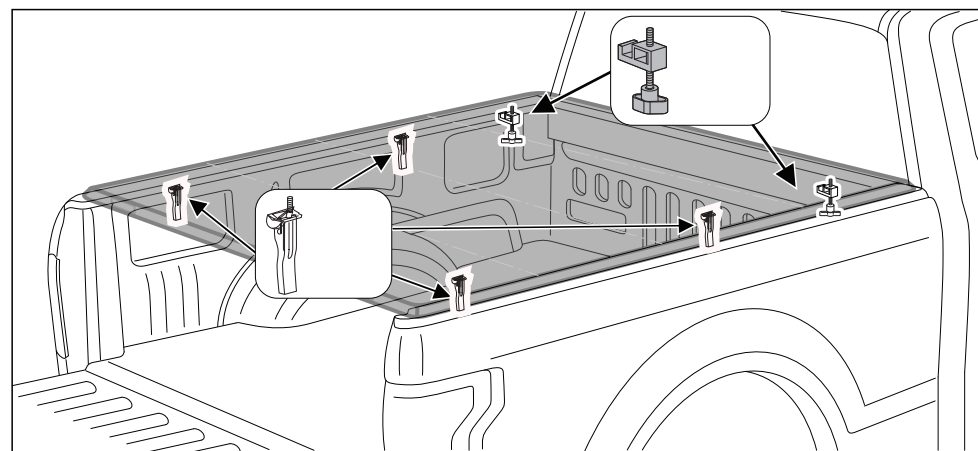
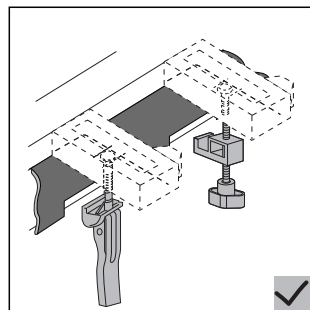
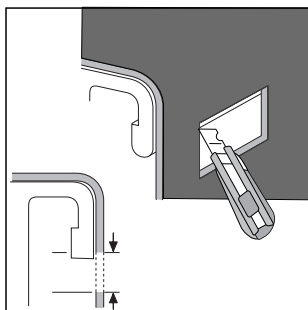
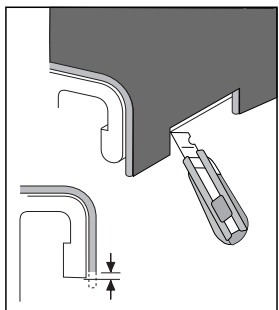

## Step 8:

1. Close the tailgate. Installation completed.

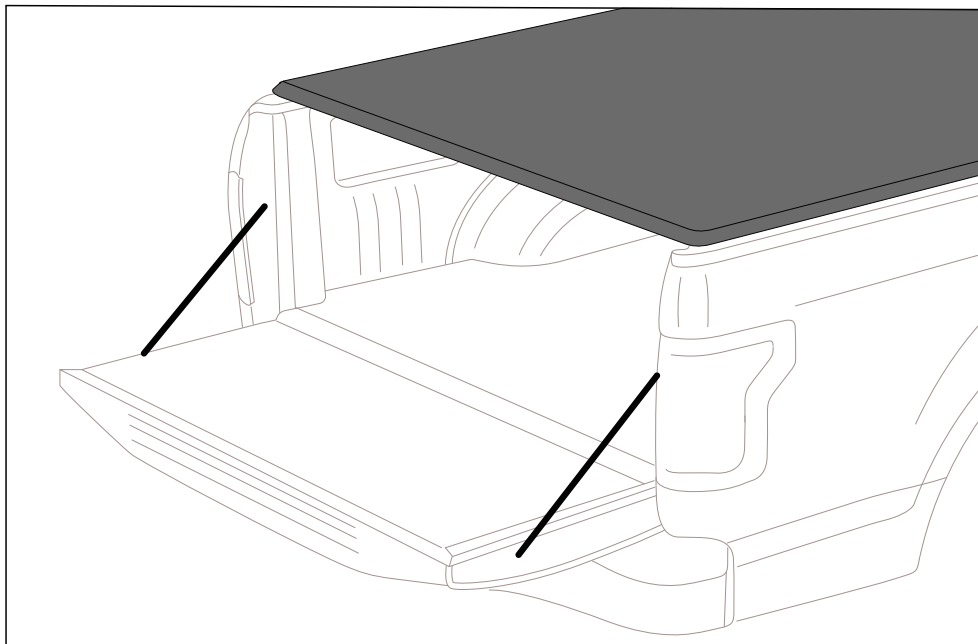

## Fold up the Cover:

1. Open the tailgate.
2. Release and fold up the rear clamps.

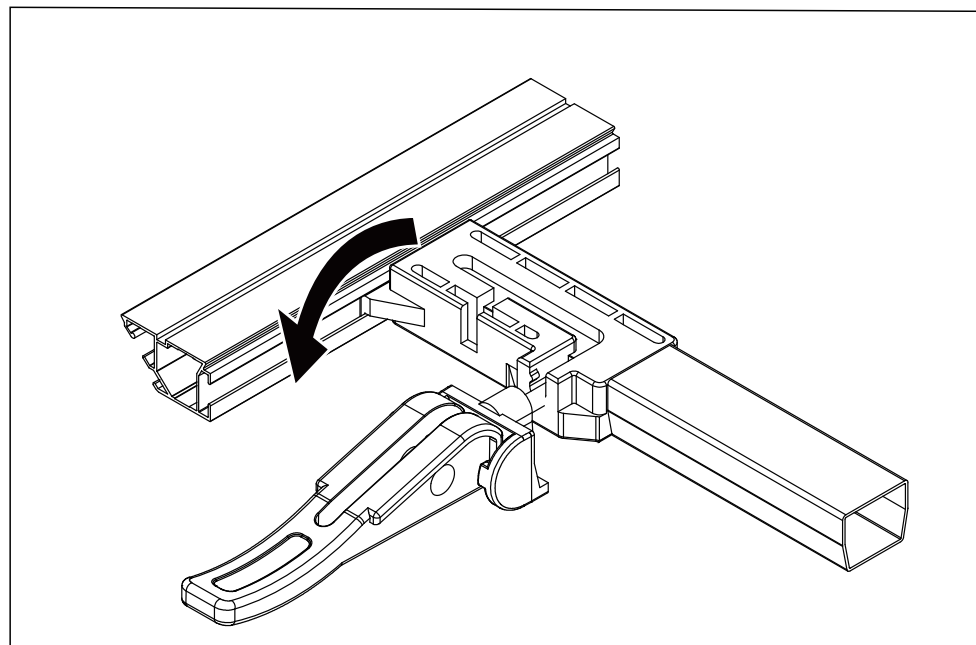
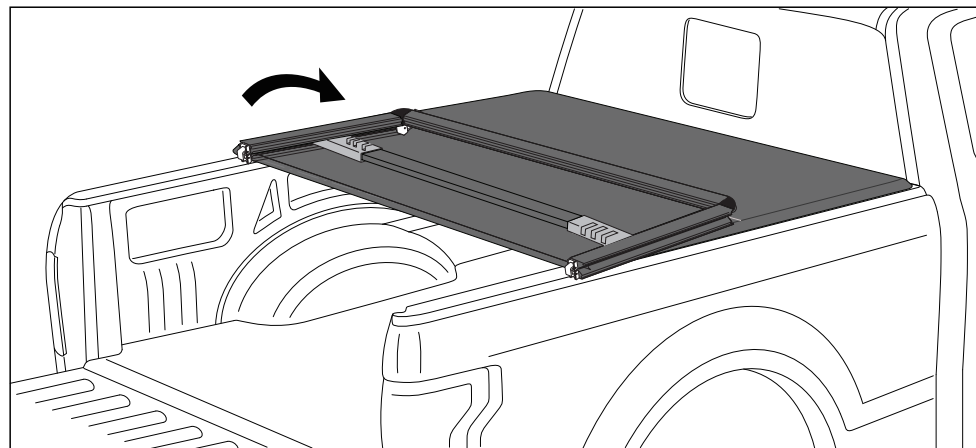

3. Fold up the cover towards front.
4. Secure the safety buckles.

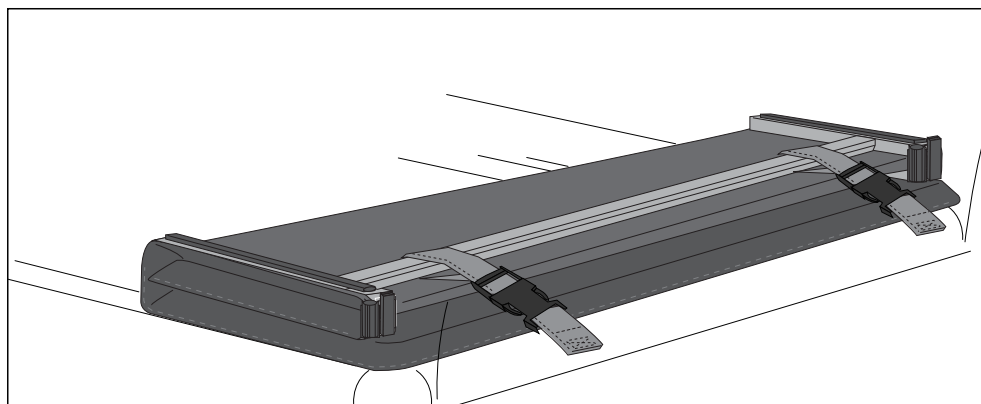
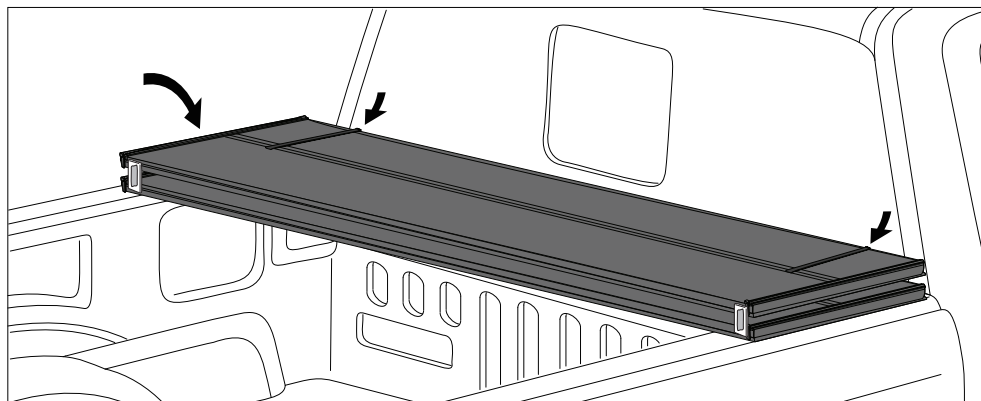

5. After the tonneau cover installed, periodic check to ensure all clamps and buckles remain secure and tight.