

CARE AND USE INSTRUCTIONS

Before Installation:

Read this instruction carefully before starting installation.

Proper tools will improve the quality of installation and reduce the time required.

2004-2015 models and 2016-current models using different mounting hardware.

If missing parts or any damage found, please take a picture and contact us.

Professional installation would be highly recommended.

Step 1:

1. Locate (3) mounting positions each side.
2. Clean the factory threaded inserts and studs.
3. Clean the sealant and dirt around mounting positions.

Step 2:

For 2016-Current Models

1. Attach the bracket to inner rocker panel.
2. Secure bracket on rocker panel with (2) M8 hex bolts, (2) M8 flat washers.

For 2004-2015 Models

1. Attach the bracket to inner rocker panel.
2. Secure bracket on rocker panel with (1) M8 hex bolt, (1) M8 hex nut, (2) M8 flat washers.

CARE AND USE INSTRUCTIONS

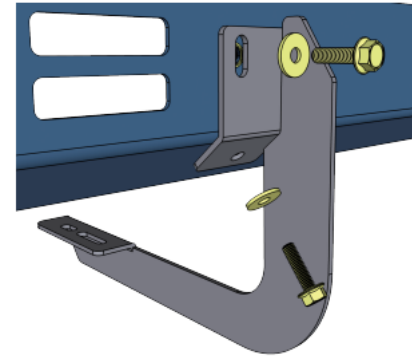

2016-Current Models

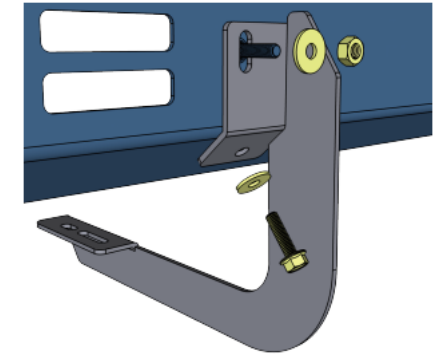

2004-2015 Models

Step 3:

1. Remove (6) M8 hex bolts and (6) M8 flat washer from the step bar.
2. Slide mounting tracks to proper positions.
3. With assistance, lift and attach the step bar to brackets.

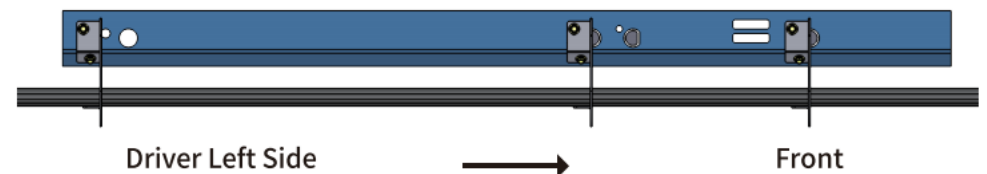
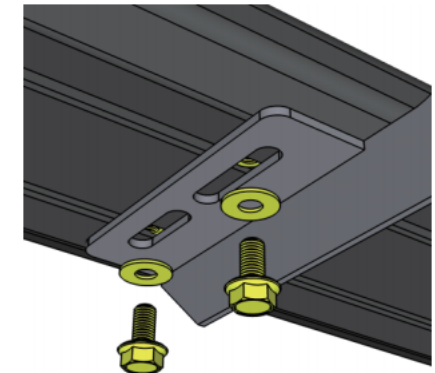

CARE AND USE INSTRUCTIONS

Step 4:

1. Tighten M8 hex bolts on vehicle with 15 ft-lbs. torque.
2. Adjust the step bar to level and tighten M8 hex bolts with 15 ft-lbs. torque.
3. After the step bar installed, periodic check to ensure all mounting hardware remains secure and tight.

CARE AND USE INSTRUCTIONS

Part List:

	Qty.	Description
①	× 3	Driver Side Bracket
②	× 3	Passenger Side Bracket
③	× 12	M8 Hexagon Flange Bolt
④	× 12	M8 Flat Washer
⑤	× 12	M8 Hexagon Flange Nut
Pre-Install on Step Bar		
⑥	× 12	M8 Hexagon Flange Bolt
⑦	× 12	M8 Flat Washer

