



Always secure  
the latches



Do not overload  
cargo



Use seal strips for  
exposed gap



Remove all items  
including snow before  
folding the panels

- We recommends the users to check the cover is securely attached to the truck bed from time to time. Look for any loosen bolts and handles due to road vibration, cargo contact, etc.
- Use a sponge or soft cloth with water to gently remove any dust or dirty off the surface.
- The term warrants defects in materials, missing items and workmanship of this product.
- If the owner installs improperly, modifies, misuses, repairs, or uses the product other than its intended design, any damages that are not caused by defective materials or workmanship such as normal wear and tear, vehicle accidents, acts of God. etc. will not be covered by the warranty.
- The warranty only applies to the original purchaser and does not cover any subsequent owners or purchasers of the products. Proof of original purchase is required for any warranty services.
- We shall not be responsible for any incidental or consequential damages such as injury loss caused by improper use by owner or third party.
- Professional installation would be highly recommended.

## 1. Products Inventory:



Please open the package and check the quantity of accessories as follows pictures.



The fittings and replacement accessories shape in pictures only for reference, Please take the material objects as standard.

*Only Provide for not Pre-Install Buckle Mount One*

Hex key 3.0mm \* 1 **G**

Hex Socket Cap Screws \* 4 **H**

Bag Buckles Mounts \* 2 **F**



Seal Strip \* 1 **B**



Knobs \* 2 **C**



Aluminum Buckles \* 2 **D**



Handles \* 4 **E**

Tonneau Cover \* 1 **A**

### Replacement part



Bag Buckles \* 1 **I**



Bag Buckles Mounts \* 1 **F**



Plastic Sliding \* 2 **J**

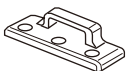

Buckle Holder \* 1 **K**

### Optional Accessories

*Only for Jeep/Toyota/Nissan with utility track, not for other models.*

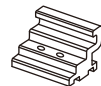

Aluminum Blocks \* 6 **L**



Hex key 2.5mm \* 1 **M**



Set Screws \* 12 **N**

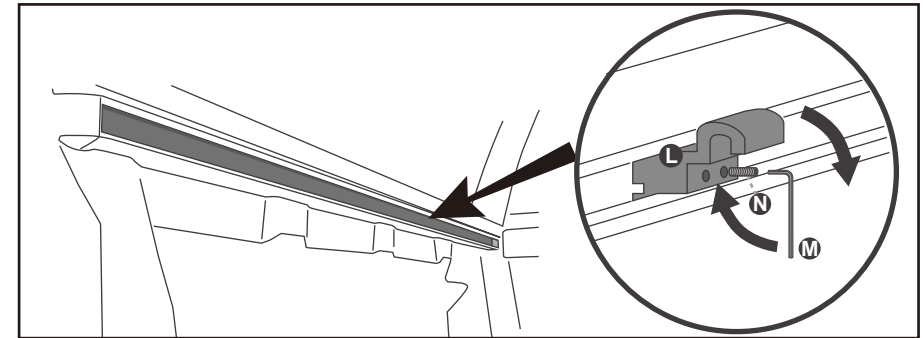

Slide the aluminum blocks into track, then adjust the position and tighten the set-screws.

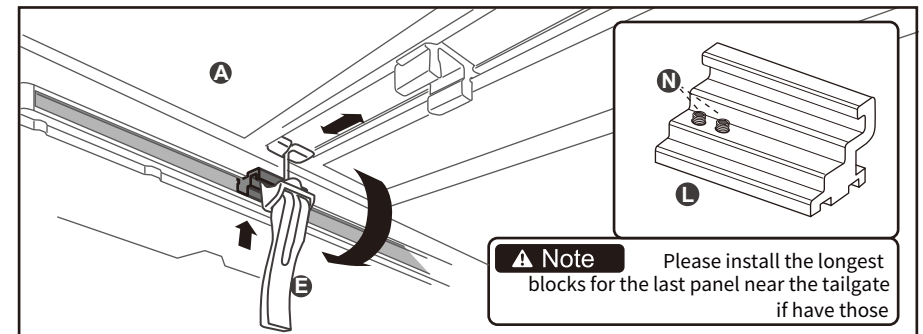

Secure the six clamps on the aluminum blocks.

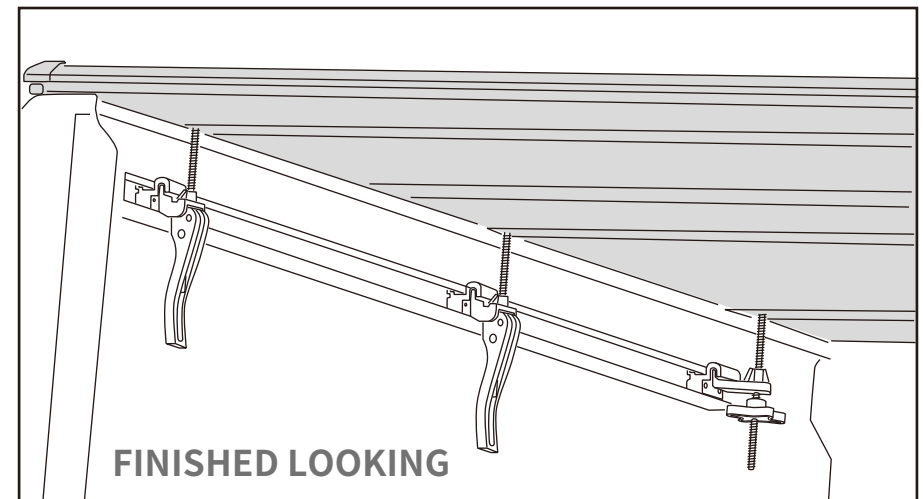

**FINISHED LOOKING**

## 2. Installation Guide:

6. Do the same procedure as Step 4 for the last cover. Sometimes the seal strip in the last panel will be wrinkle during transportation, pull it higher in initially installing for better water resistant. And close the tailgate to check whether the cover laying down flat or any gaps between the cover and bed.

### 3. Long Bed Liner Tips



#### Note:

- If your truck bed covered with long bed liner on the metal side of bed, please cut the plastic off, so the clamp can contact and lock on the metal of side.
- For the safety usage, please do the same way for the all 6 lock positions. Please noted that only Lock on the plastic may loosen the damp handle, and cause the tonneau cover open during driving.

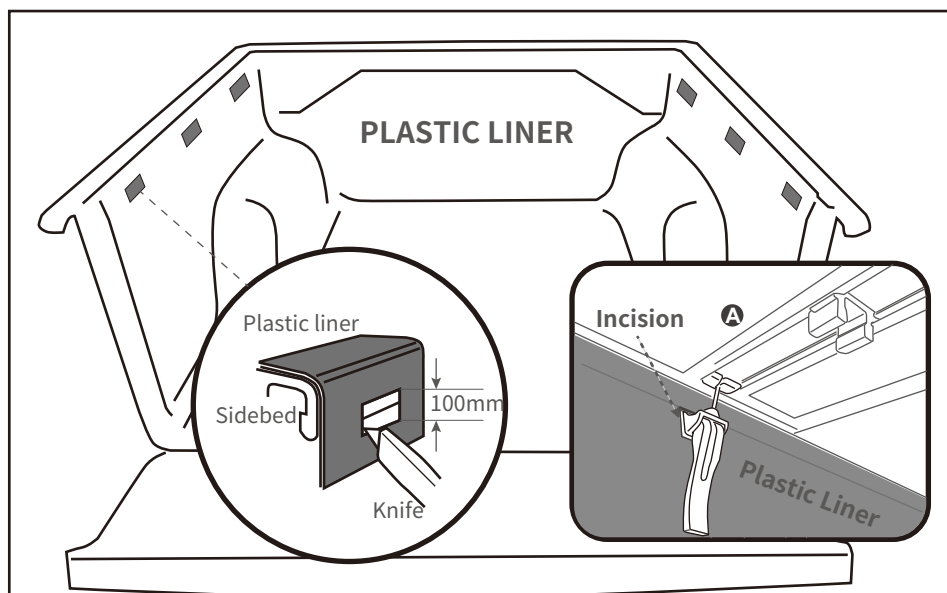

### 4. Vehicles with Utility Track (Toyota/Nissan/Jeep)

These items will need to be installed manually.

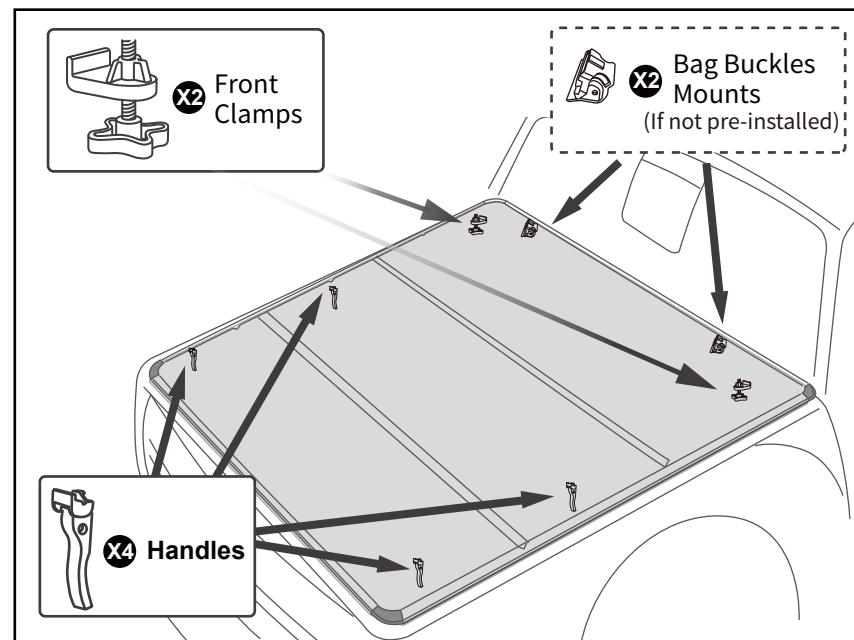

#### STEPS

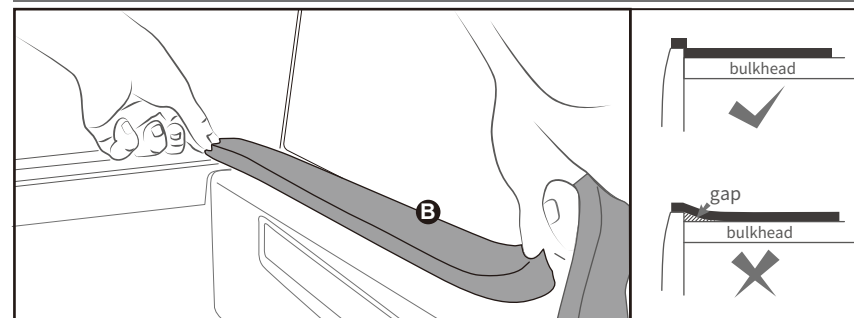

1. Firstly, Stick the seal strip on the front of truck bed. And then, cut down the strip parts on the two junction steps between bulkhead and side bed. Finally, cut the strip a little longer than the length of the bulkhead bed.

- ▲ Ensure there is no gap between the strip and the corner of tonneau cover.

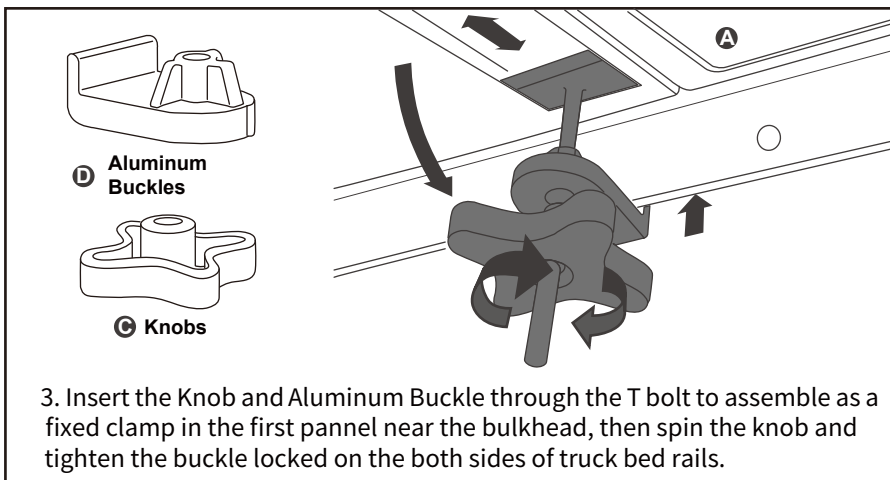
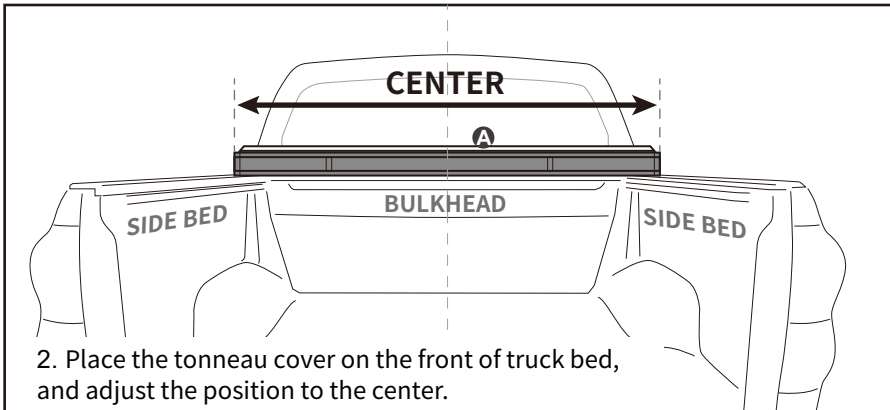

#### ⚠ Note

If the cover pre-installed the Two buckle Mounts, Please go to STEP 4.

If not, align the Buckle Mounts according to the holes position in the front bar of tonneau cover, Fasten the screws with the hex key.

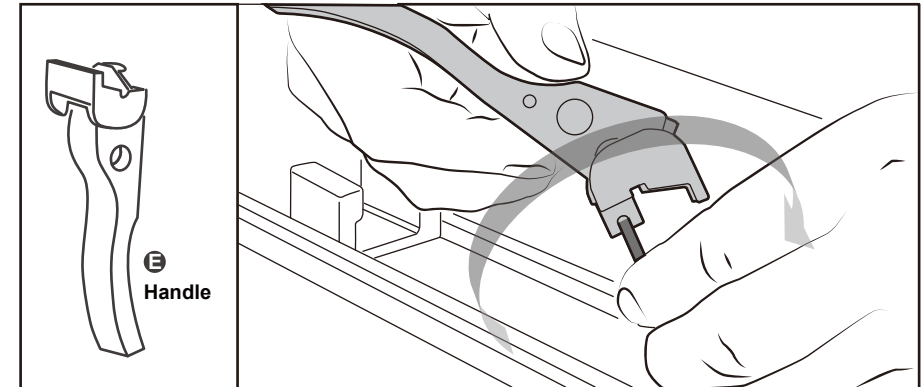
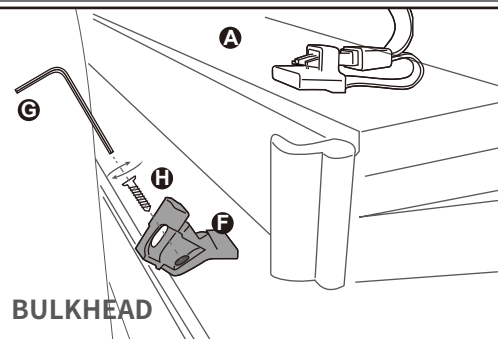

4. Insert the handle through the T bolts to assemble as a clamp handle, unfold the second cover.

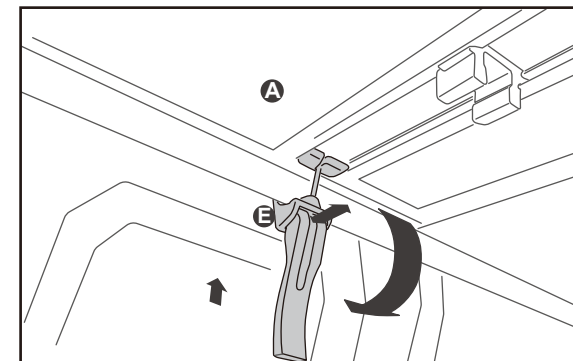

5. Spin the clamp handles up and push down the handle to ensure the lip locked in the both sides of truck bed rails. Ensure the handles secure tightly on the bed rails. Then unfold the third cover without the fixture. (If the triple cover, please go to step 6 directly.)

