

BEFORE INSTALLATION

- Professional Installation would be highly recommended, please seek assistance at local automotive shop if you have any difficulties in installing.
- Safety comes first ! Do not start to work on any vehicle without protection.
- An assistant would be better assist you in the bumper disassembly work.
- Keep cautions to prevent being scratched when working on any parts from the body of the vehicle.
- Do not touch the bulbs or the wire assembly before they are cooled to avoid the burns.

PRODUCT NUMBER

OEM : 15034929, 15034930, 5977737, 5977738, 5977459, 5977460, 5976837, 5976838



STEP 1

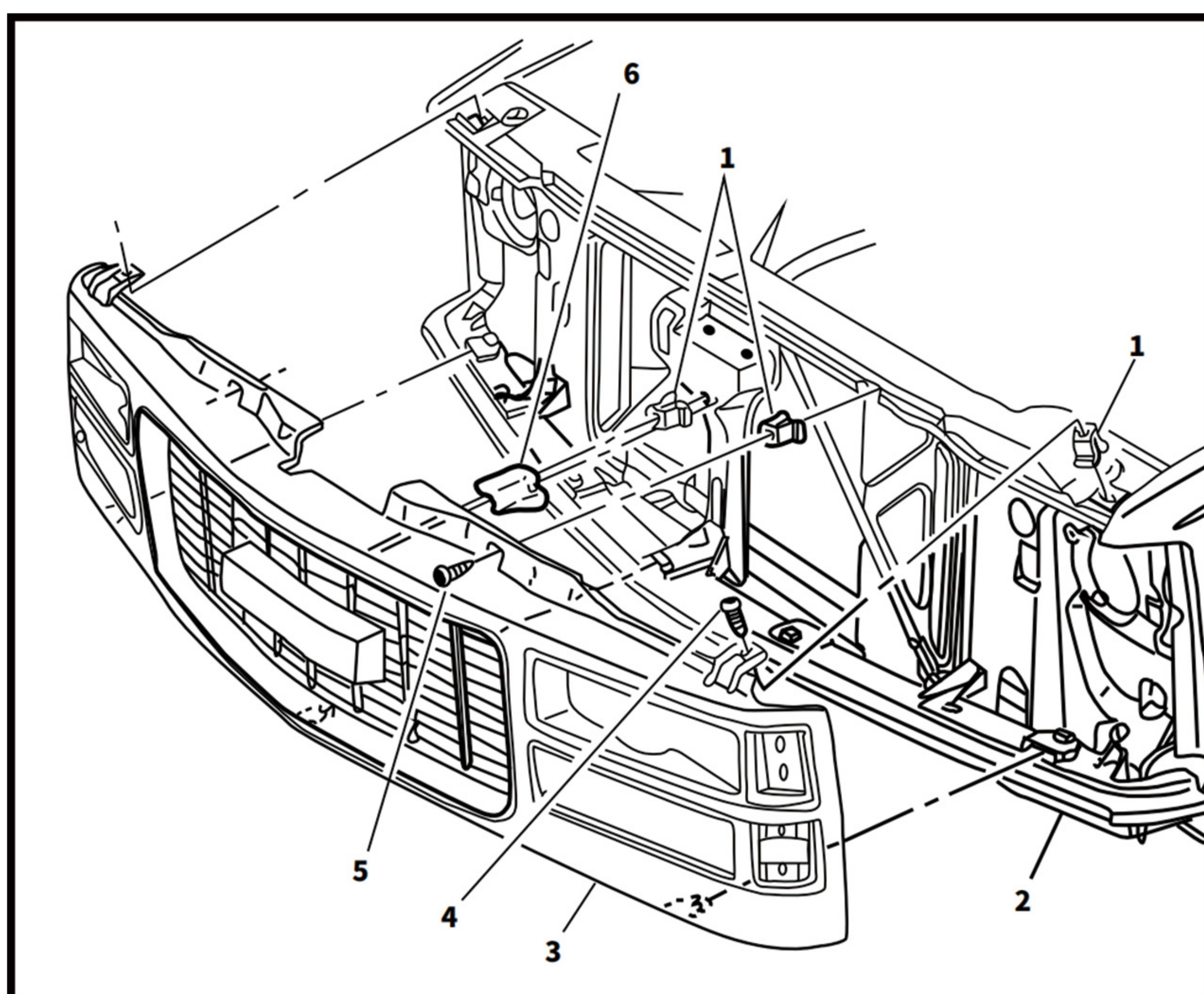

1. Open the hood.
2. Remove (4) 7mm bolts securing the radiator grille to radiator bracket.
3. Remove (1) 7mm bolt behind Gold Bow Tie symbol.

STEP 2

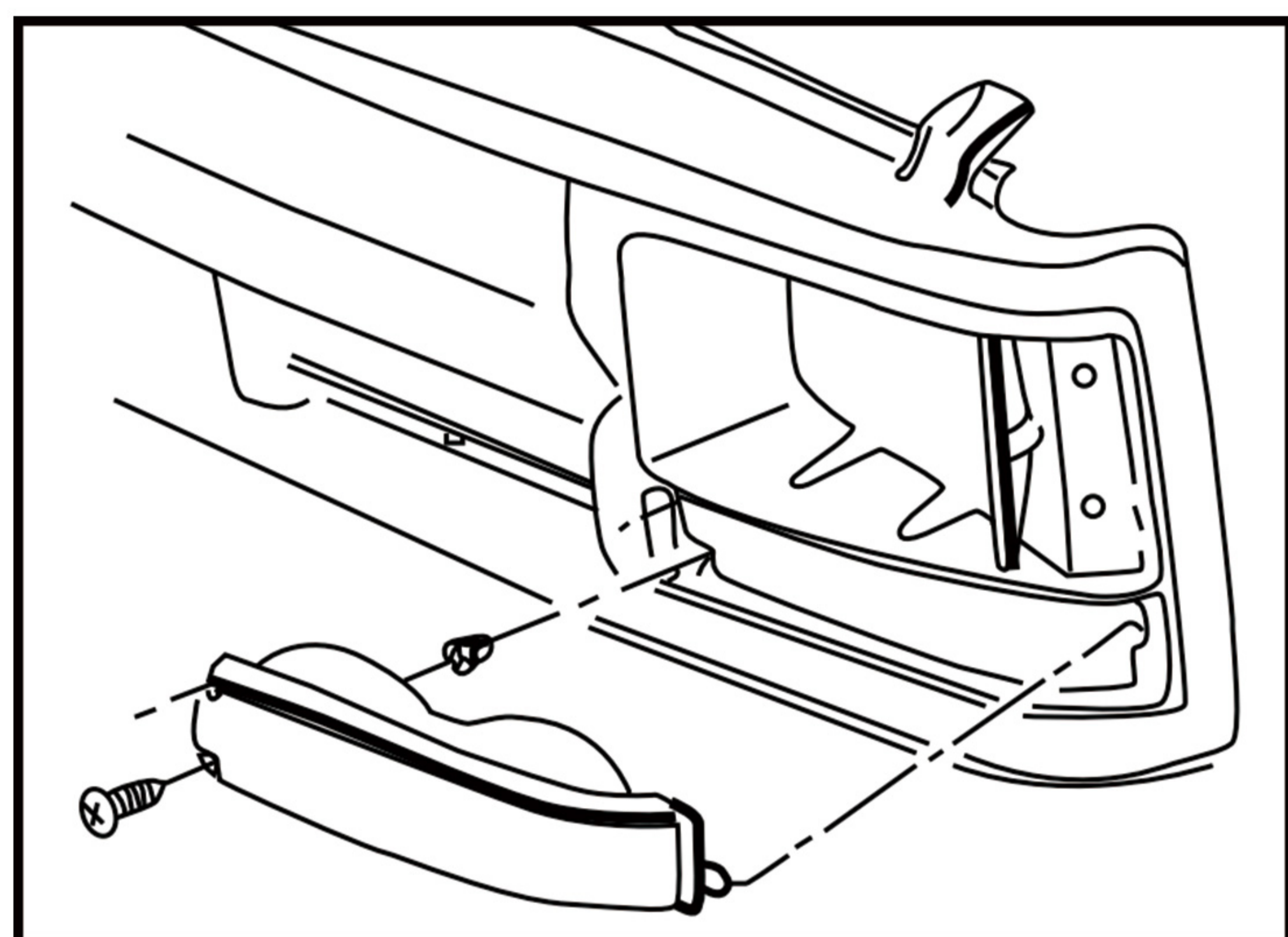

1. Remove (8) screws securing both side signal parking lamps.
2. Twist signal parking light sockets counterclockwise and remove the signal parking lamp housing from the radiator grille.
3. Twist side mark light sockets counterclockwise and remove the corner lamp housing
4. Disengage clips and remove the radiator grille.
5. Remove (8) 13mm nuts securing (4) corner lamps on the radiator grille.
6. Remove (4) corner lamps.

STEP 3

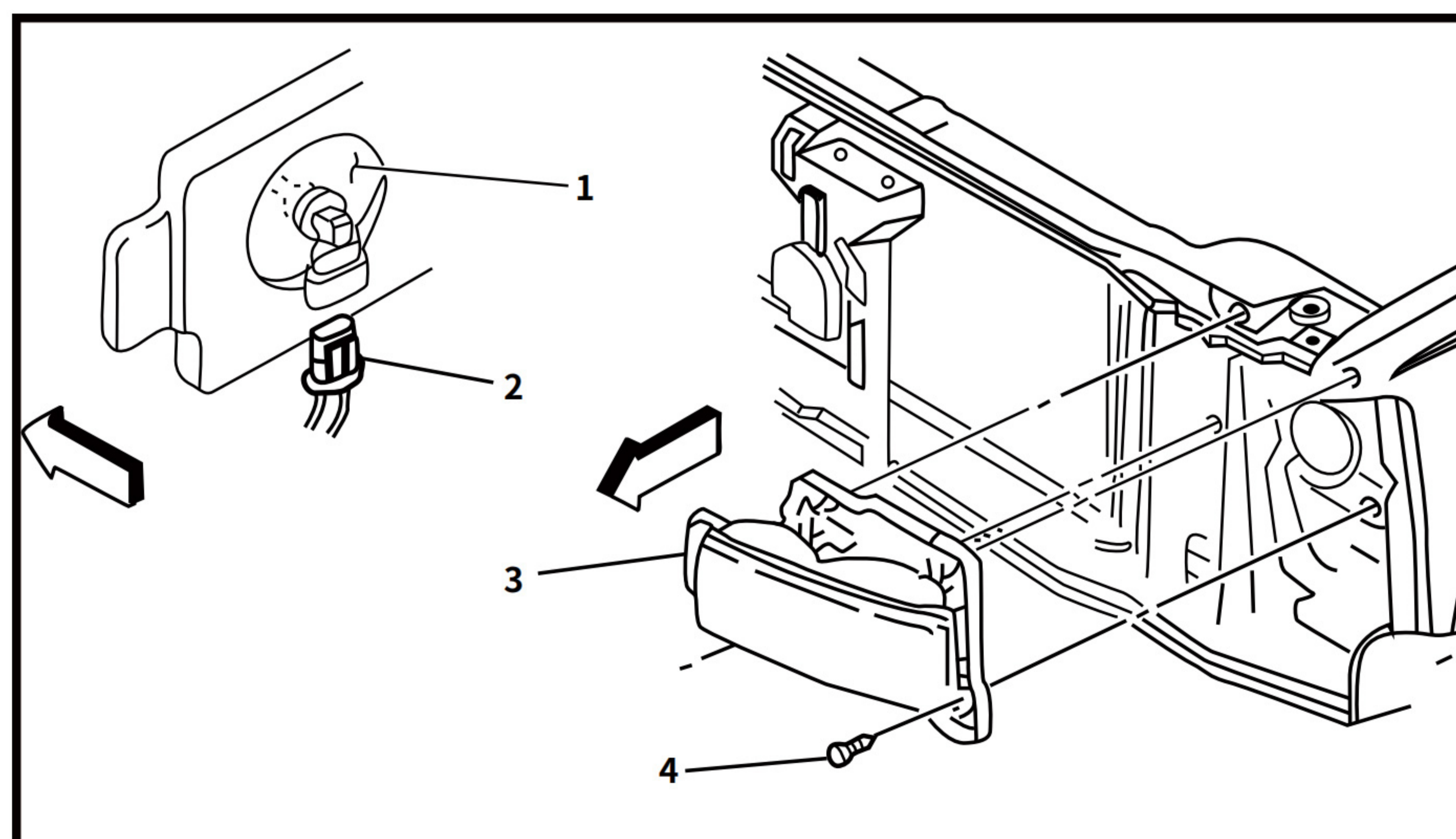

1. Remove (4) 10mm bolts securing headlamp on the radiator bracket.
2. Twist high beam and low beam bulbs counterclockwise and remove from the old headlamp.
3. Remove the old headlamp.

STEP 4

1. Insert and lock high beam and low beam bulbs into the new headlamp.
2. Attach the new headlamp to radiator bracket and secure with (4) 10mm bolts.

STEP 5

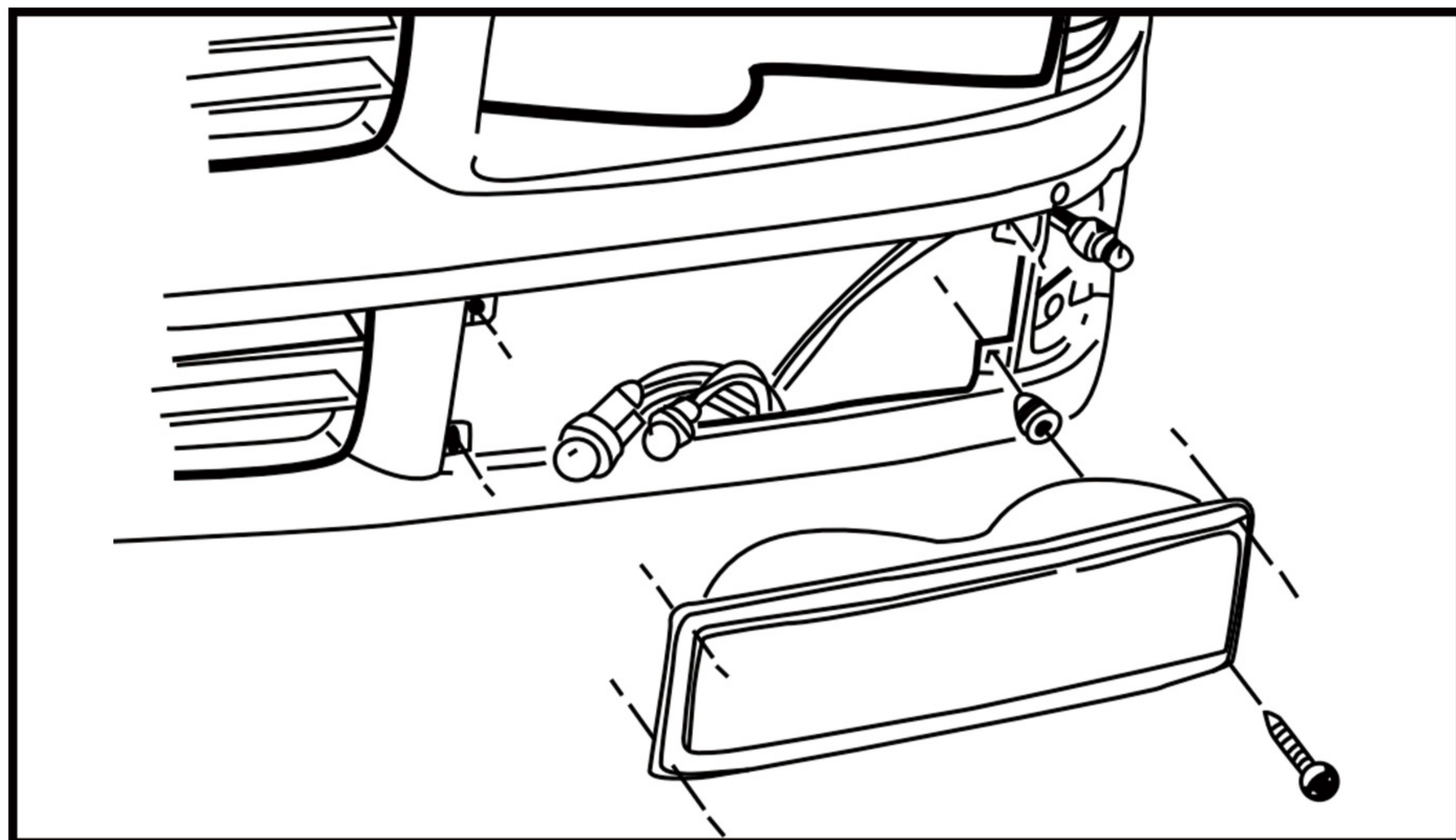

1. Repeat step 3 to step 4 on the other side.
2. Install (4) new corner lamps to the radiator grille with (8) 13mm nuts.
3. Attach the radiator grille on radiator bracket, engage clips and install (5) 7mm bolts.
4. Insert and lock side mark light sockets into corner lamps.
5. Insert and lock signal parking light sockets into the new signal parking lamps.
6. Attach the new signal parking lamps to radiator grille and secure with (8) screws.

WARM TIPS

Product Rear Structure

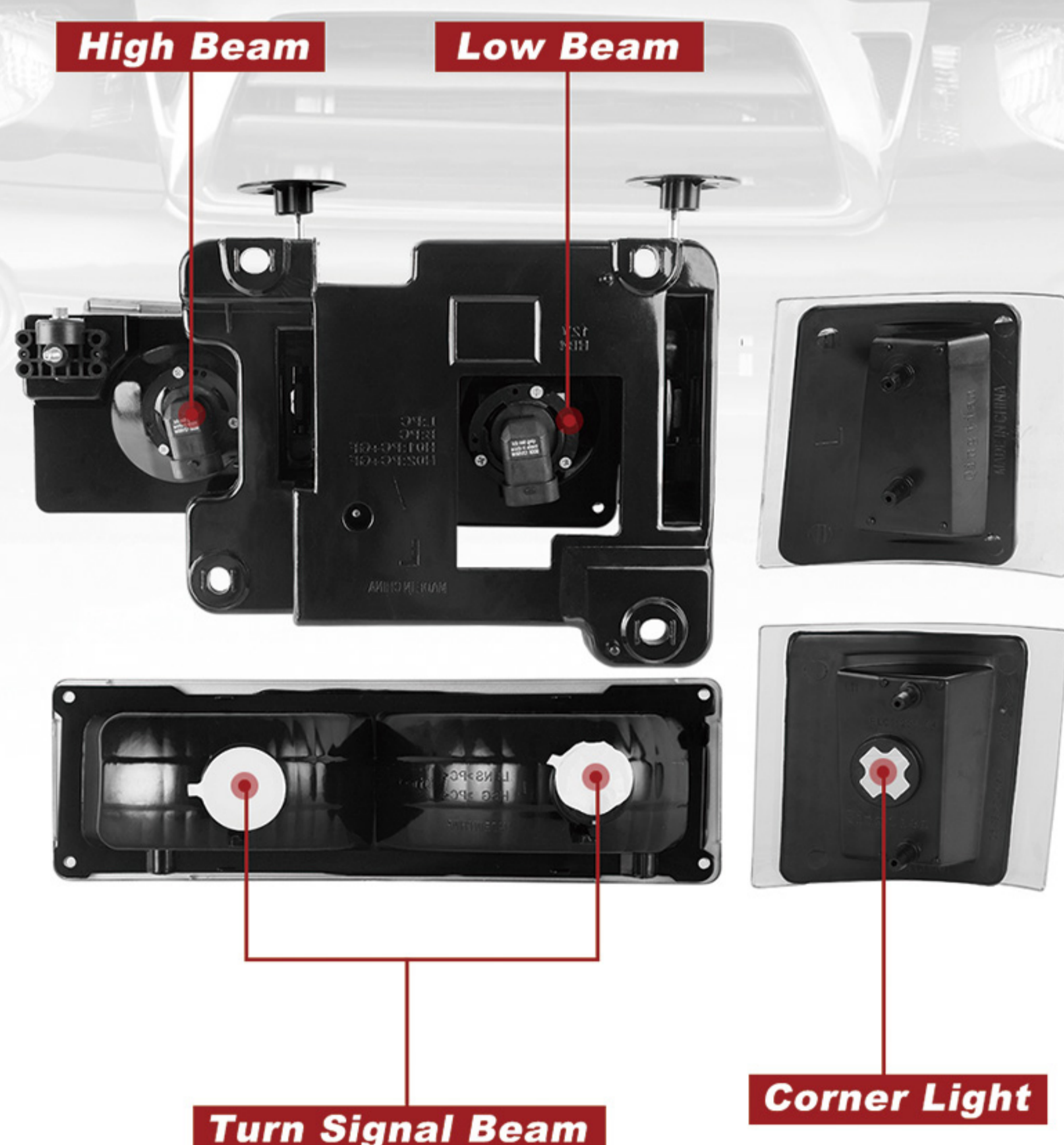

Before you begin to adjust the light, make sure check the alignment of your lights first. Park the vehicle about 10 to 25 feet from the wall with the lights aimed at the wall. The centerlines of the headlights should not be any higher than 3.5 feet above the ground.

1. Find the adjustment screws.
2. Adjust the headlights individually.
3. Adjust the vertical field.
4. Test your results.