

Tools Required

16mm 13mm Socket
16mm Wrench
Ratchet
Torque Wrench

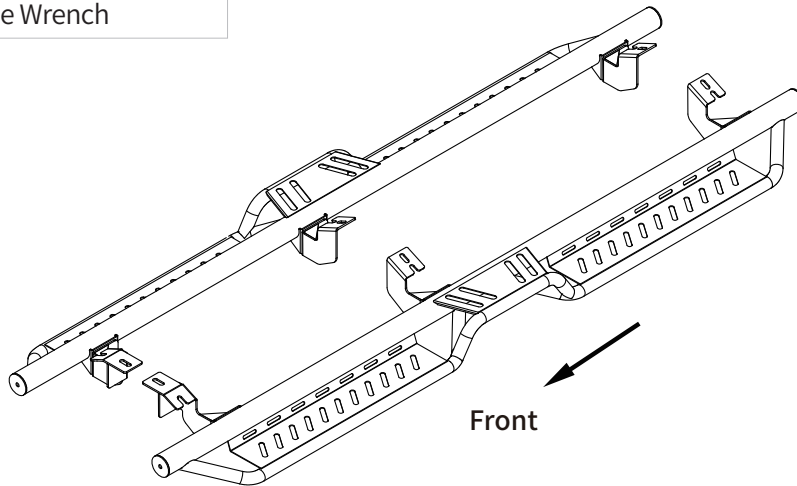

Before Installation:

Read this instruction carefully before starting installation.

Proper tools will improve the quality of installation and reduce the time required.

If missing parts or any damage found, please take a picture and contact us.

Professional installation would be highly recommended.

Step 1:

1. Locate (3) mounting positions each side.
2. Remove factory plugs or hex bolts from mounting positions.
3. Clean the sealant and dirt around mounting positions.

Step 2:

1. Attach bracket to the rocker panel and secure with (2) M8 hex bolts, (2) M8 flat washers, (2) M8 lock washers.
2. Repeat to install all brackets. Do not fully tighten.

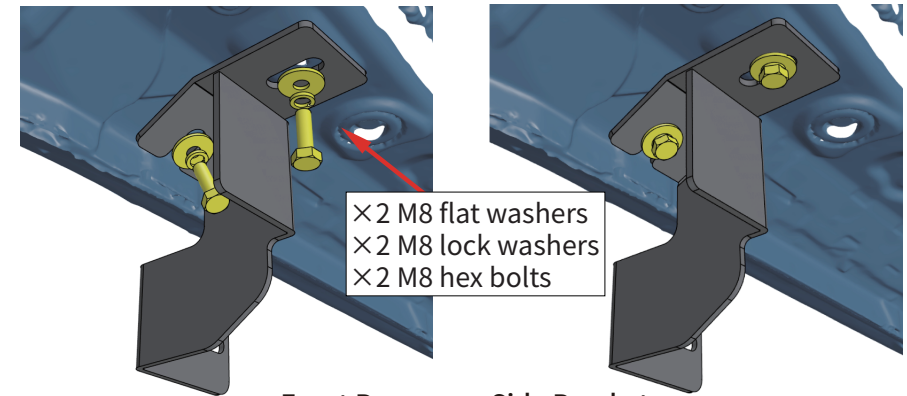

Front Passenger Side Bracket

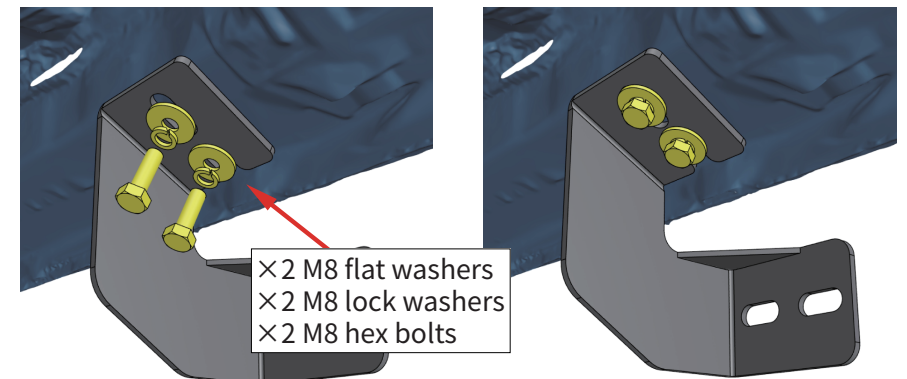

Center/Rear Passenger Side Bracket

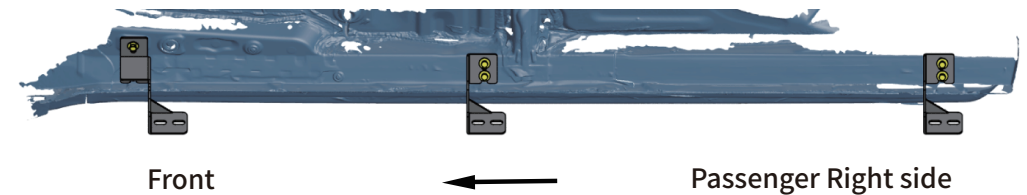

Step 3:

1. With assistance, lift and attach the step bar to brackets. Align bottom edges of the step bar mounting holes with the bracket mounting holes.
2. Secure the step bar on brackets using (6) M10 hex bolts, (12) M10 flat washers, (6) M10 lock washers, (6) M10 hex nuts.

Note: Insert the M10 bolts from the step bar side. Tighten the M10 hardware after the step bar is fully settled.

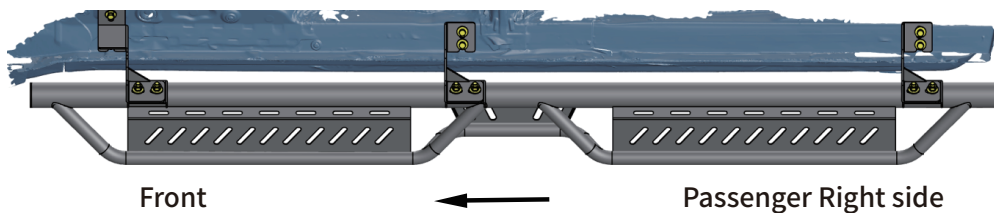
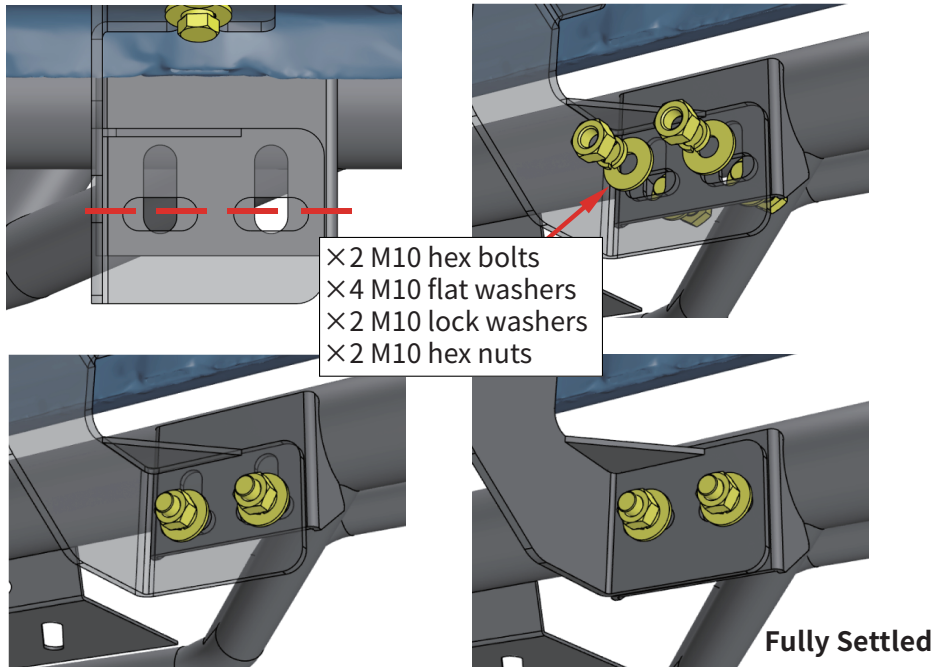

Step 4:

1. Tighten M8 hex bolts with 15 ft. lbs. torque.
2. Tighten M10 hex bolts and nuts with 31 ft. lbs. torque.
3. After the step bar installed, periodic check to ensure all mounting hardware remains secure and tight.

Part List:

	Qty.	Description
①	×1	Front Driver Side Bracket
②	×2	Center/Rear Driver Side Bracket
③	×1	Front Passenger Side Bracket
④	×2	Center/Rear Passenger Side Bracket
⑤	×12	M10×30 Hexagon Bolt
⑥	×12	M8×25 Hexagon Bolt
⑦	×24	M10×25 Flat Washer
⑧	×12	M8×24 Flat Washer
⑨	×12	M10 Lock Washer
⑩	×12	M8 Lock Washer
⑪	×12	M10 Hexagon Nut

