

Suit For 02-08 Dodge Ram Poket Style Fender Flares

FEATURE

High quality injection molding fender flares

Made from light weight impact resistance Polypropylene, non-cracking, non-warping, 100% UV-resistant.

Professional installation is always recommended

Step 1: Before Installation

A. Fit: Fit of the flare to vehicle should be confirmed. Some filing, sanding, or cutting may be adopted for proper fit if necessary.

B. Painting: (optional) if paint is desired it must be done prior of installing flares on vehicle. Clean outer surface with a good grade degreaser.

C. Metal protection: Rust resistance paint of all exposed fasteners and bare metal should be done BEFORE installing flares. Undercoating the inner fender wells should be done AFTER flare attachments have been completed.

D. Flares may interfere with existing decals on vehicle. If you wish. Remove decals prior to installation of flares.

TOOLS FOR EASY INSTALLATION

- Utility Knife
- #2 Phillips Drive bit
- 7/32 Socket
- T45 Torx Bit
- Socket Wrench
- Marker

Included in Hardware Kit:

- | | | | | | |
|---|--|--|---|---|---|
| 1.  Allen Bolt 40 pcs | 2.  Washer 40 pcs | 3.  Nut 40 pcs | 4.  Push-in Clip 10 pcs | 5.  Self tapping screw 10 pcs | 6.  SW1-0052 T-45 Torx Bit 1 pcs |
| 7.  Expand Fastener 10 pcs | 8.  ET1-0002, Edge Trim Tool 1 pc | 9.  GP1-0008 Duro (UC02/S 70) Edge Trim 360 inches | | | |
-

STEP 2 - Edge trim installation

A. Peel two to three inches of red vinyl backing away from Edge Trim tape. Applying the adhesive side of the edge trim to the inner side of the flare, affix the edge trim to the top edge of the flare (the portion that comes in contact with the vehicle).

B. Press edge trim into place along the top edge of the flare in one-foot increments, pulling red vinyl backing free as you continue to work your way around the top edge of the flare.



STEP 3 - Edge trim tool procedures

Installation (Left Front Flare Shown)



Use allen key to tight allen bolt ,washer & nut firmly on every pocket of the fender flares first then place the flare on the vehicle with best position. Apply 2 Push-In Clip into the mounting slot in flare and secure it to the vehicle as shown .Fasten the existing factory screws into the original location that were previously removed.

Installation (Left Rear Flare Shown)

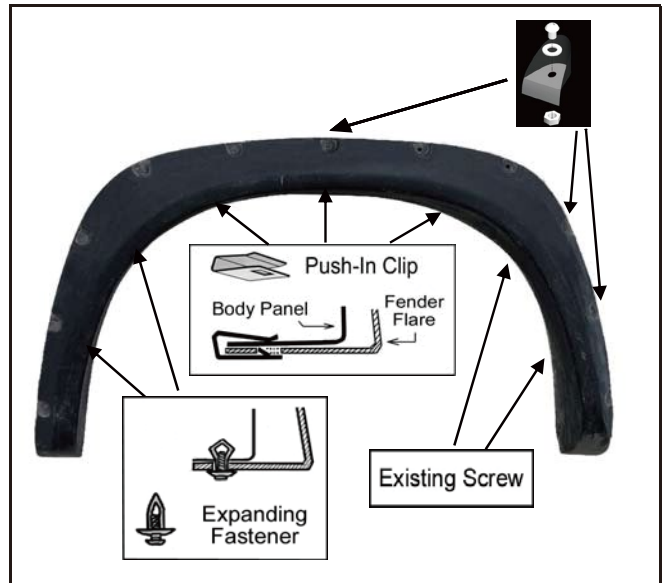

Use allen key to tight allen bolt ,washer & nut firmly on ever pocket of the fender flares first , then place the flare on the vehicle with best position. Apply 3 Push-In Clip into the mounting slot in flare and secure it to the vehicle. Apply 2 Plastic Expanding Fastener into the mountin g slot in flare and secure it to the vehicle as shown. Fasten the existing factory screws into the original location that were previously removed.

(Optional B;Use the included self tapping screw to instead of the Expanding Fastener.where the Expanding Fastener is not workable on the different condition of the fenger,or it may be used for extra secure when it's needed.)