

Part List

①	X6	Clamp Foam Pad
②	X1	Front Seal Strip (for Ford ONLY)
③	X1	Tailgate Seal Strip
④	X2	Spare Plastic J-Hook
⑤	X2	Spare Clamp Cross Joint
⑥	X4	M6 Nut Column
⑦	X2	Rear Clamp Handle Set
⑧	X1	Spare Plastic Buckle

⚠ Warning:

1. Tonneau cover must be completely secured in the closed position or opened position while driving. DO NOT DRIVE with cover in partially opened position.
2. Clean the debris before folding the tonneau cover.
3. Professional installation would be highly recommended.
4. Period check to ensure all clamps remain secure and tight.
5. Remove the tonneau cover before towing the truck from rear.
6. Do not drive without safety clamps.
7. The tonneau cover needs to be removed in extreme weather, such as typhoon, hurricane, heavy rain and hail.



Always secure the latches



Do not overload cargo



Use seal strips for exposed gap



Remove all items including snow before folding the panels

Step 1:

1. Clean the bulkhead and bedrail before installation.
2. For Ford trucks stick the seal strip onto the bulkhead.

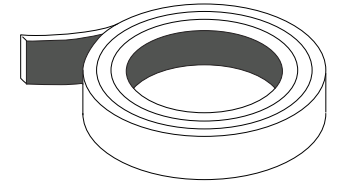
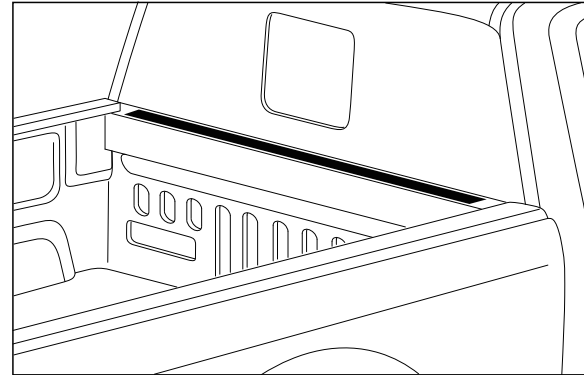

Step 2:

1. Place cover assembly on front truck bed rail against the cab.
2. Release safety buckles.

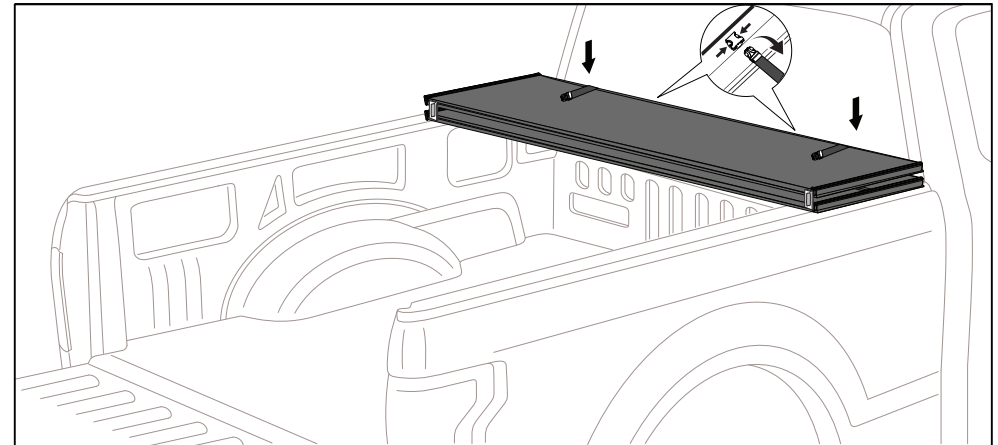

Step 3:

1. Fully unfold the cover towards rear.
2. Ensure the cover aligns on truck bed.

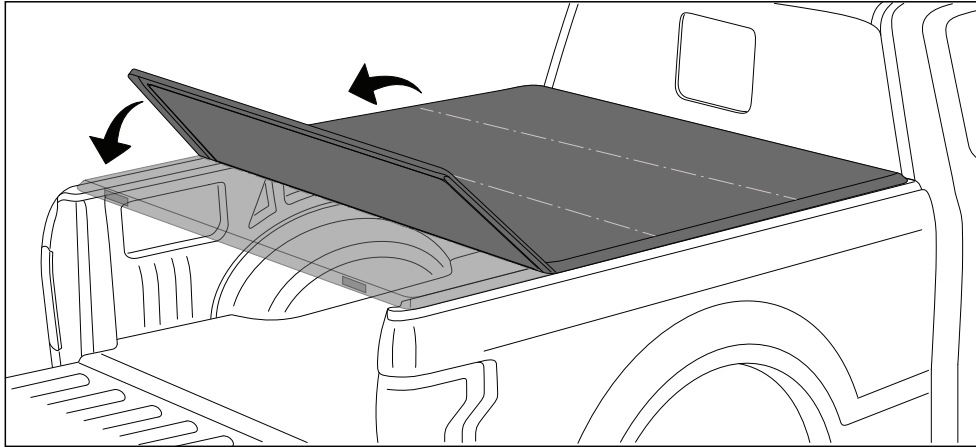

Step 4:

Carefully refold the cover without moving position on the truck bed.

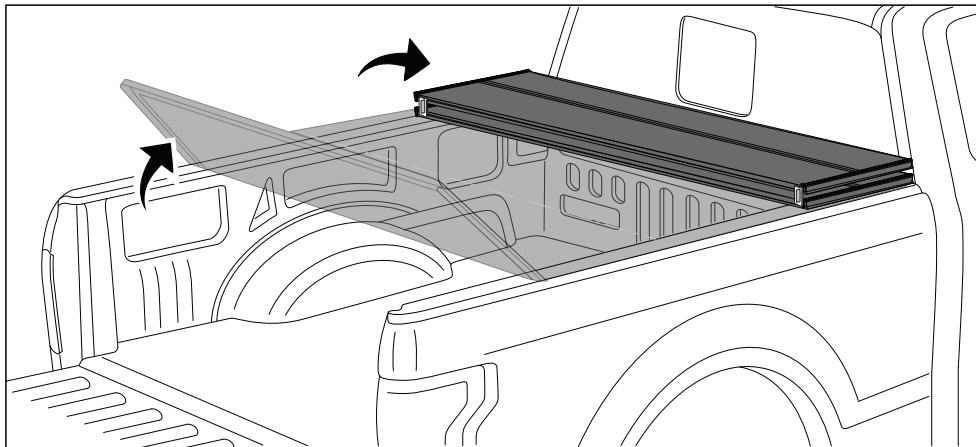

Step 5:

1. Pull down the front clamp to vertical position.
2. Loosen the knob and slide front clamp to bed rail.
3. Stick the clamp pad to mounting position on bed rail.
4. Hook the J-shaped clamp under the metal bed rail lip and tighten the knob.

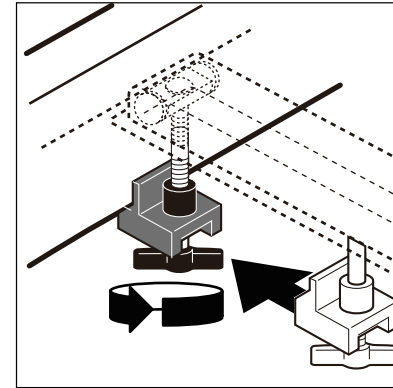

Note:
Hand tighten ONLY. DO NOT over tighten.

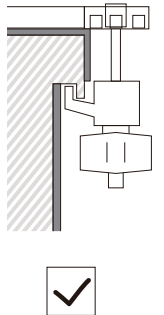
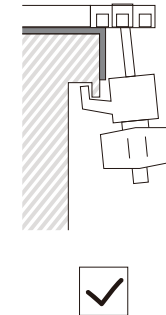
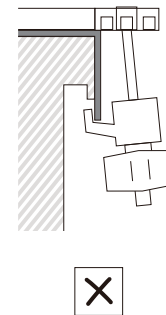
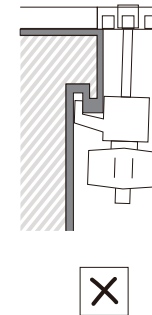

The clamps may not precisely vertical.

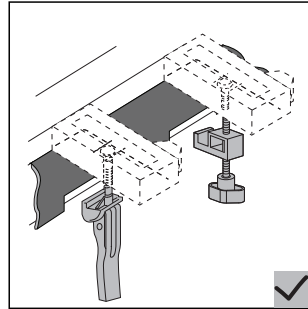
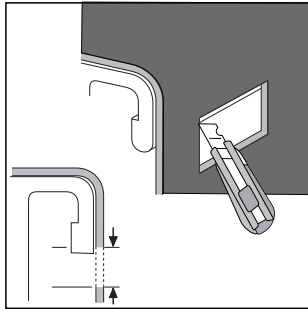
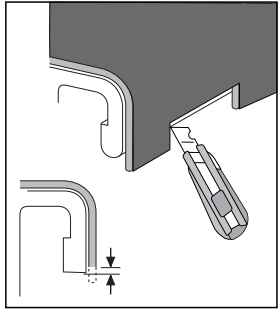

Step 6:

1. Loosen the safety clamp and attach to the bed rail lip on both side.
2. Hand tighten the knob clockwise. DO NOT use wrench or overtighten.
3. Adjust the strap to proper length. and pull the other end of the strap to tight.

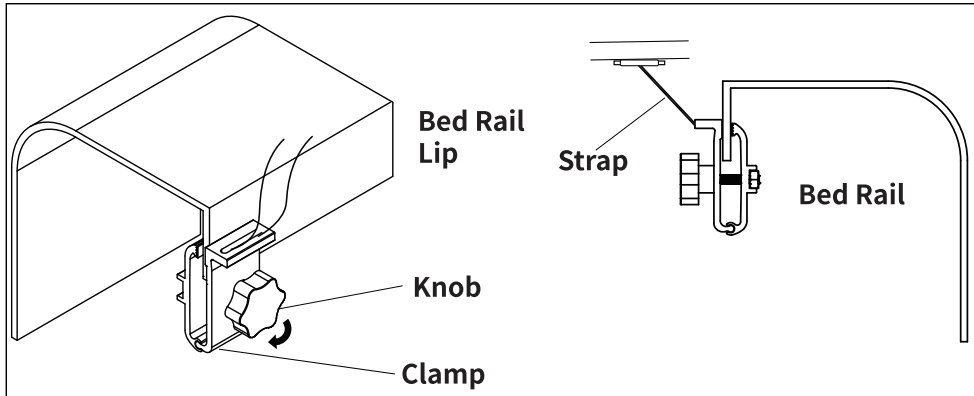

Step 7:

Carefully unfold the cover and secure the center and rear clamps.

1. Pull down the center clamp to vertical position.
2. Slide rear clamp to bed rail.
3. Stick the clamp pad to mounting position on bed rail.
4. Turn the clamp handle to adjust rear clamp to proper length.
5. Hook the J-shaped clamp under the metal bed rail lip and push the clamp handle to vertical position.
6. Install the rear clamp handles to the 4th folding, and repeat above process.

Note:

1. The clamps may not precisely vertical.
2. Insert the nut column into the clamp handle, feed the mounting bolt through the clamp handle to the nut thread, and turn counter-clockwise.

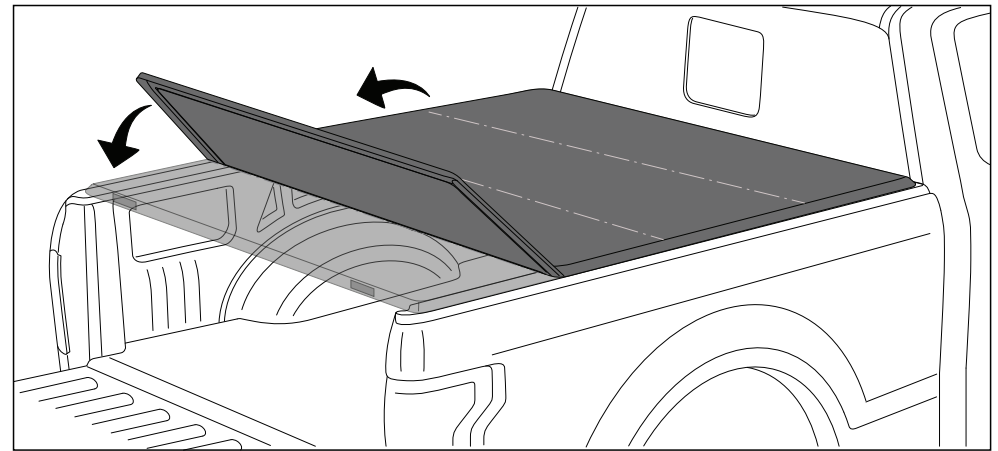

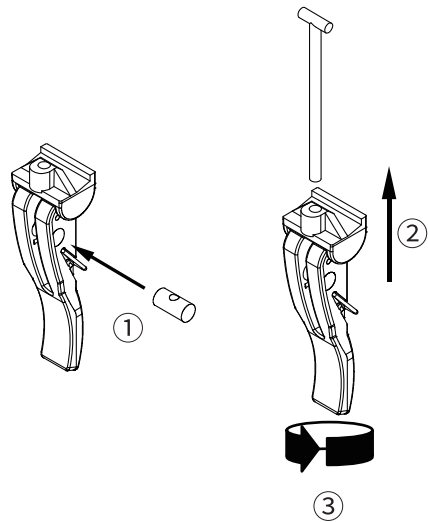
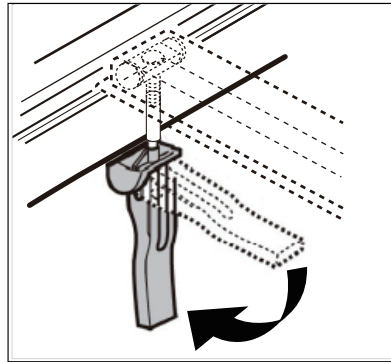
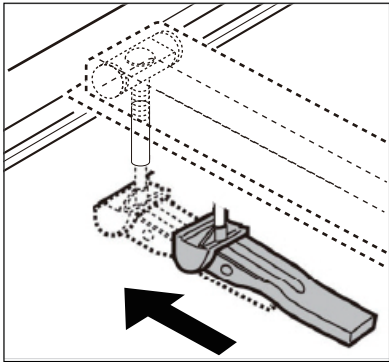

Push the spring lever when fold and unfold the clamp.

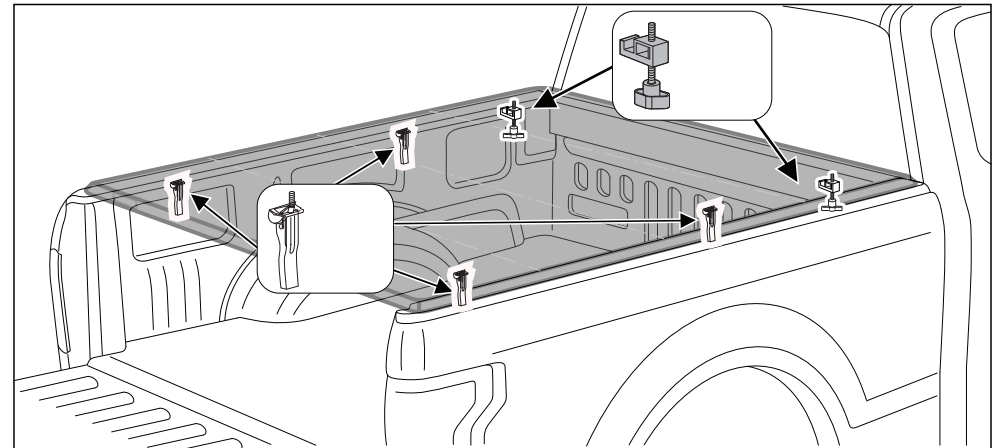
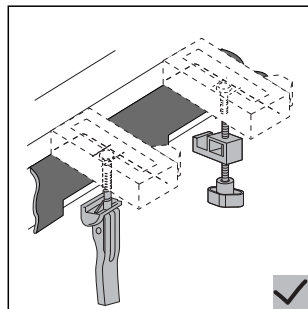
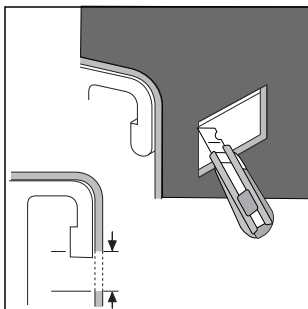
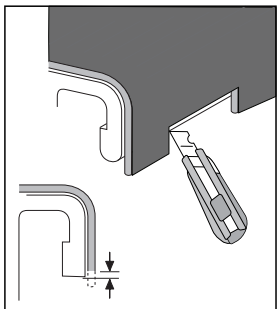

Step 8:

1. Stick on the tailgate seal strip.
2. Close the tailgate. Installation completed.

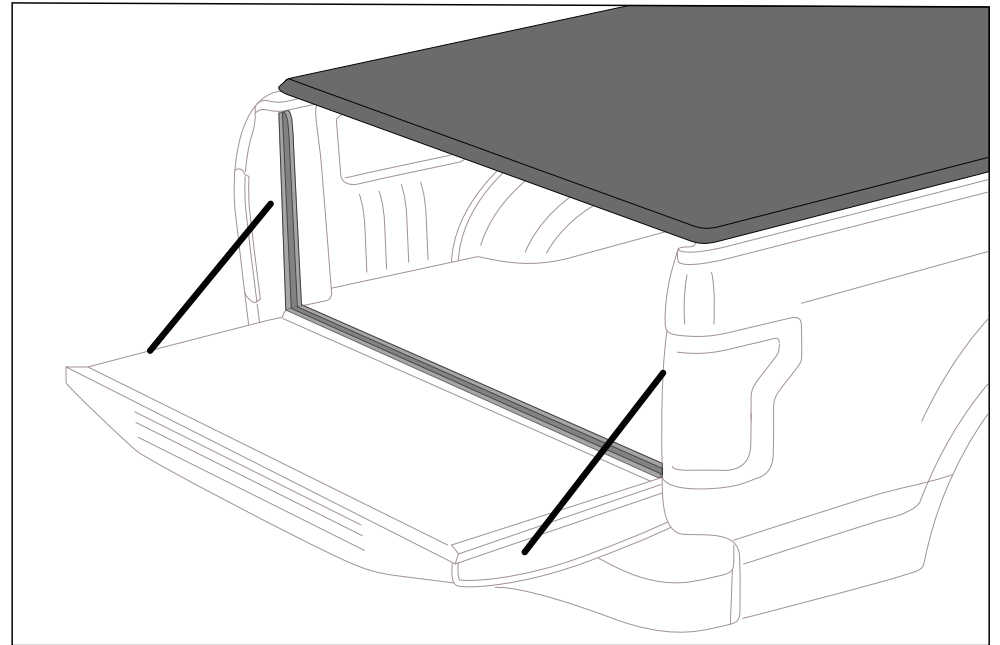

Fold up the Cover:

1. Open the tailgate.
2. Release and fold up the rear and center clamps.

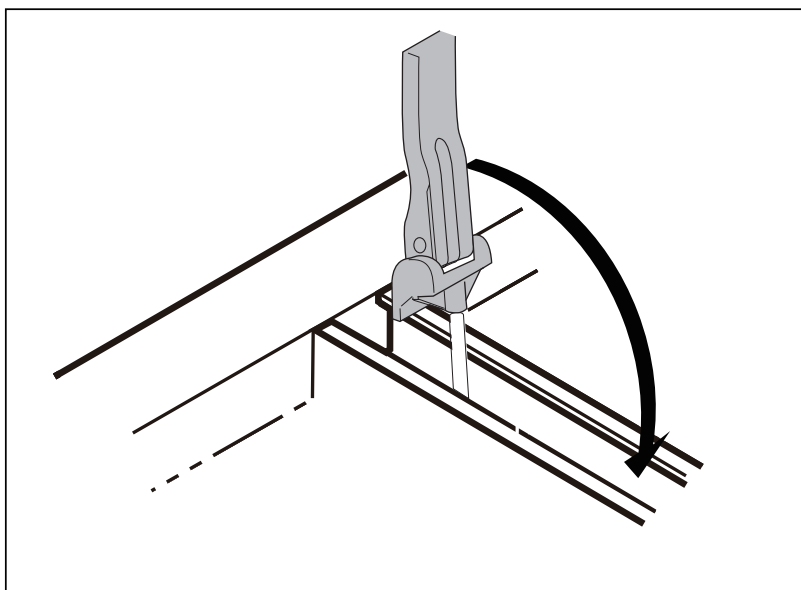
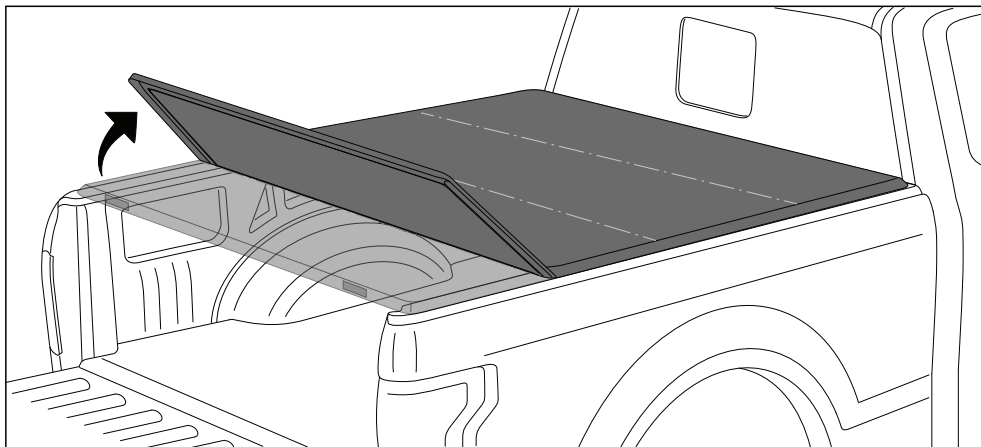

3. Fold up the cover towards front.
4. Secure the safety buckles.

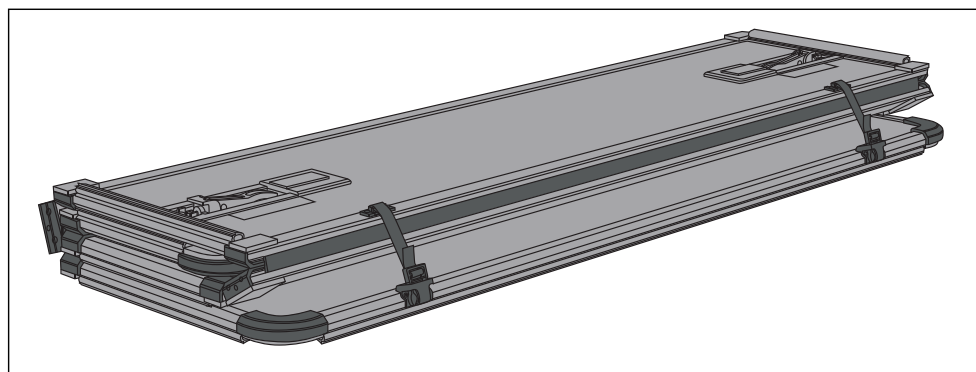
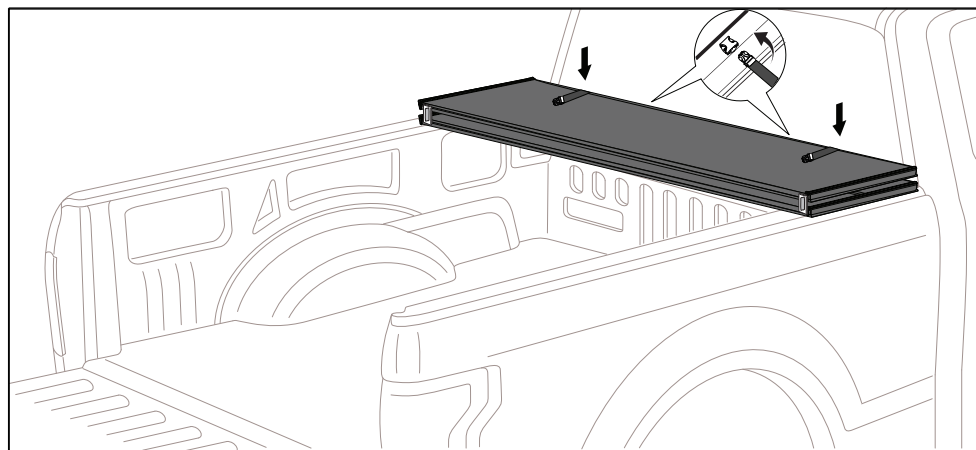

5. After the tonneau cover installed, periodic check to ensure all clamps and buckles remain secure and tight.