

## BEFORE INSTALLATION

- Professional Installation would be highly recommended, please seek assistance at local automotive shop if you have any difficulties in installing.
- Safety comes first ! Do not start to work on any vehicle without protection.
- An assistant would be better assist you in the bumper disassembly work.
- Keep cautions to prevent being scratched when working on any parts from the body of the vehicle.
- Do not touch the bulbs or the wire assembly before they are cooled to avoid the burns.

## PRODUCT NUMBER

OEM: 2C3Z13008AB, 2C3Z13008AA, 2C3Z13201AA, 2C3Z13200AA





## STEP 1

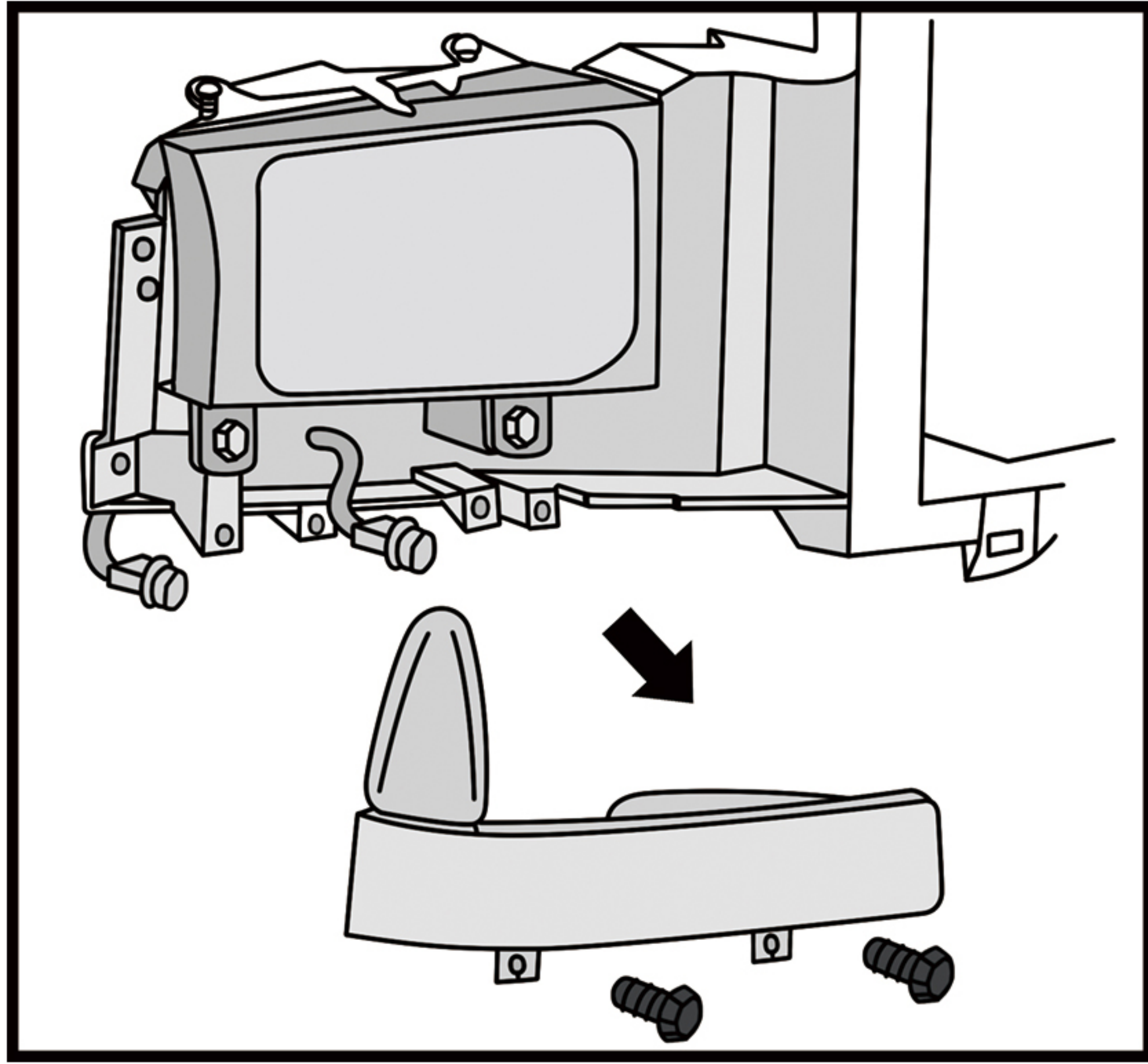

1. Remove (2) Philips screws under the signal parking light assembly.
2. Pull the signal parking light assembly forward and disconnect wire harness.
3. Twist signal parking light and side mark light sockets counterclockwise and remove from the old signal parking light assembly.

## STEP 2

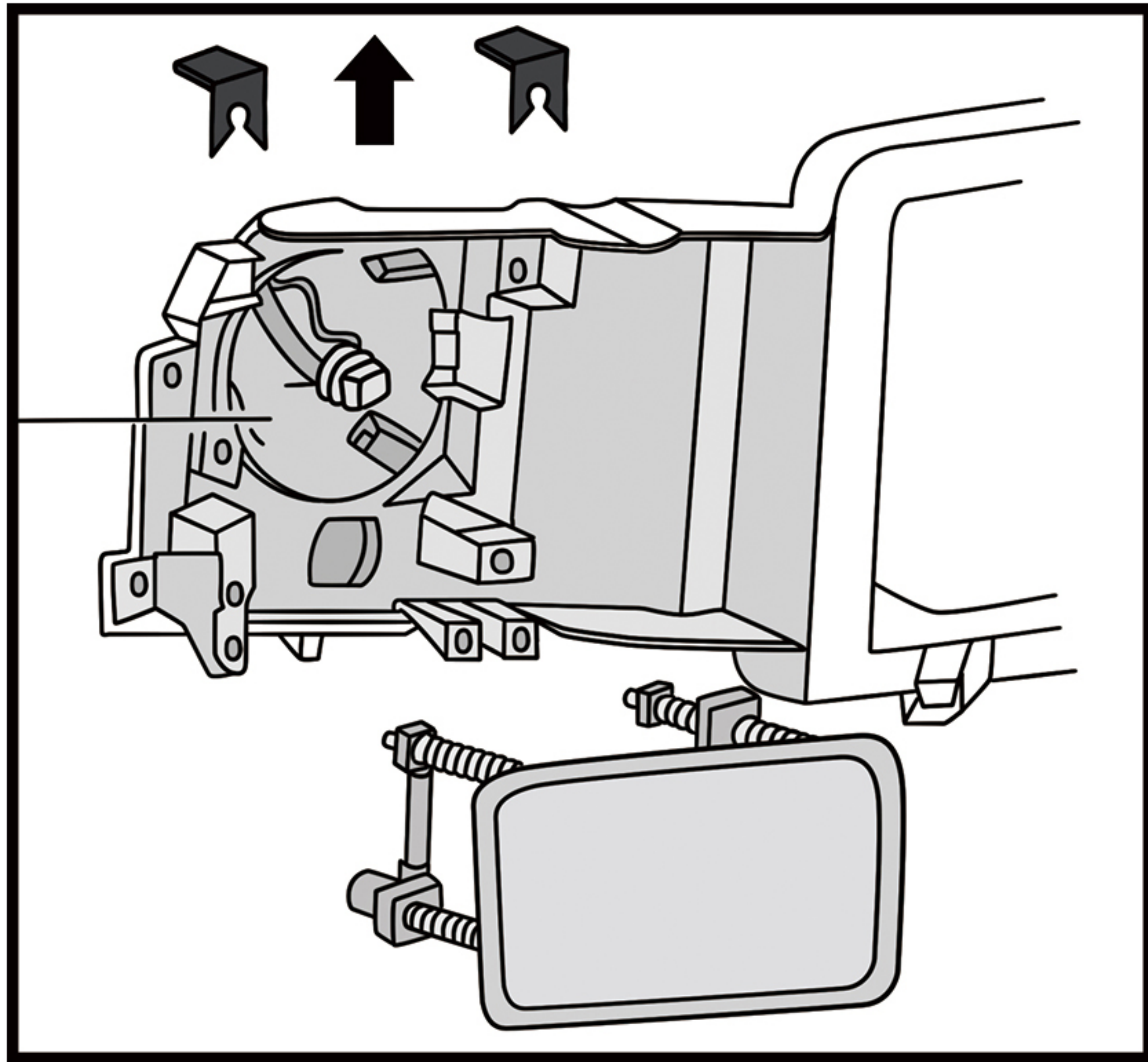

1. Open the hood.
2. Remove (2) retainers securing the headlight assembly.
3. Pull the headlight assembly forward and disconnect wire harness.
4. Turn the headlight bulb retaining ring counterclockwise to remove the headlight bulb from old headlight assembly.

## STEP 3

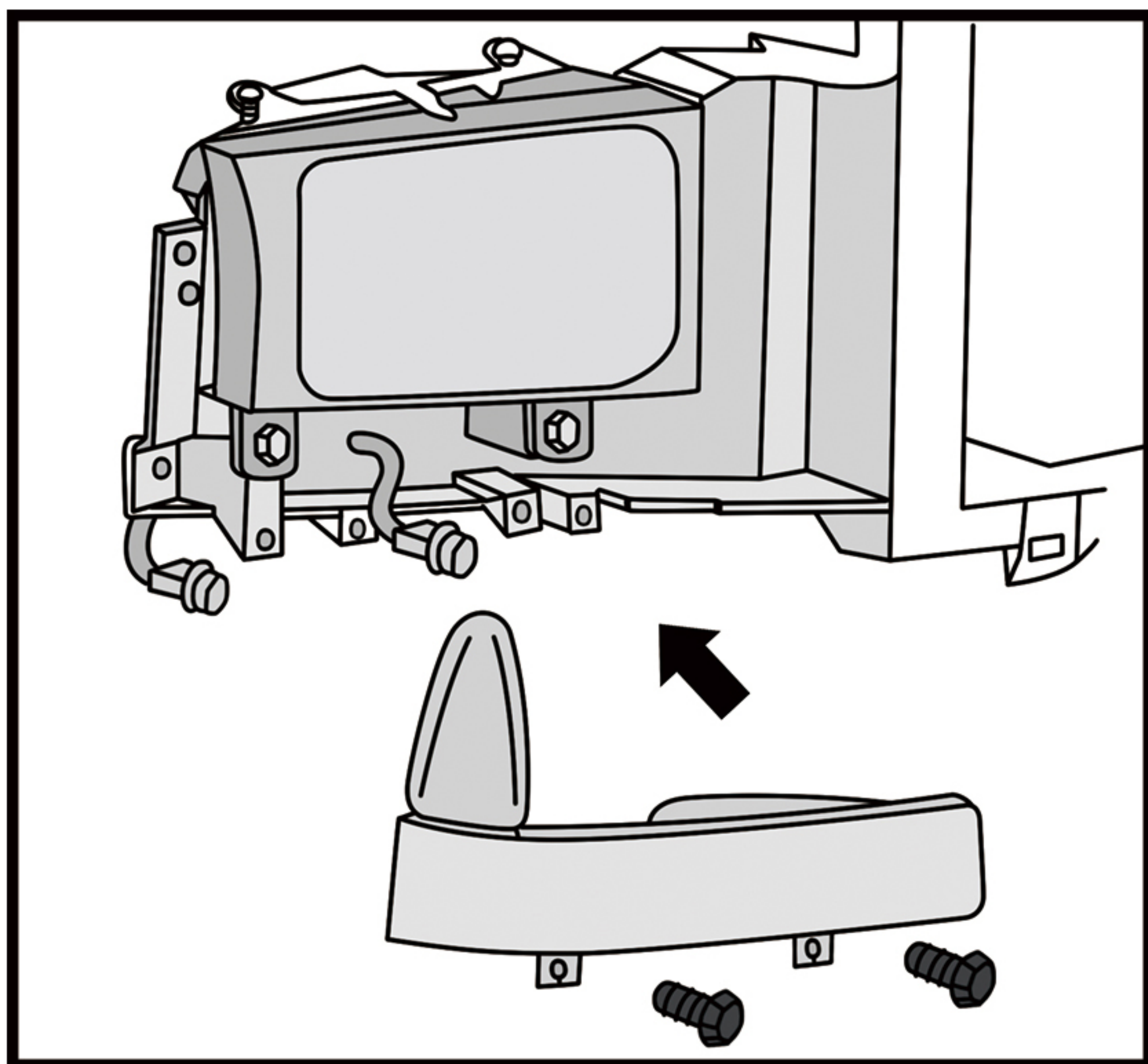

1. Insert signal parking light and side mark light sockets into the new signal parking light assembly and twist clockwise to secure.
2. Place the signal parking light assembly on vehicle, connect wire harness.
3. Guiding the signal parking light assembly into mounting position.
4. Secure the signal parking light assembly by (2) factory Philips screws.



## STEP 4

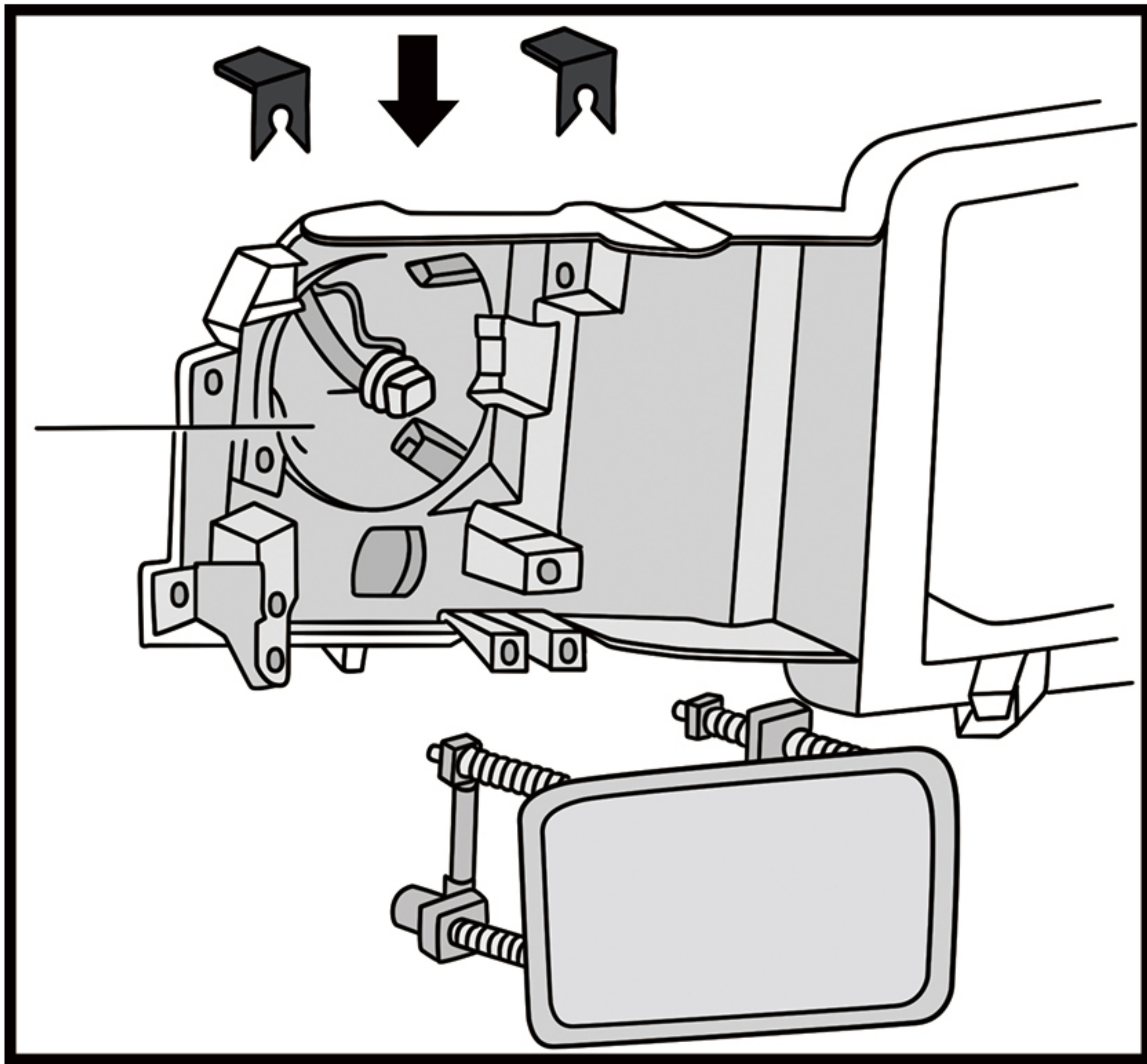

1. Insert the headlight bulb into the new headlight assembly and secure by the retaining ring
2. Place the new headlamp on vehicle, connect headlight harness.
3. Align the guiding pin with the mounting hole on body panel.
4. Secure the headlight assembly on body panel using (2) factory retainers.

## WARM TIPS

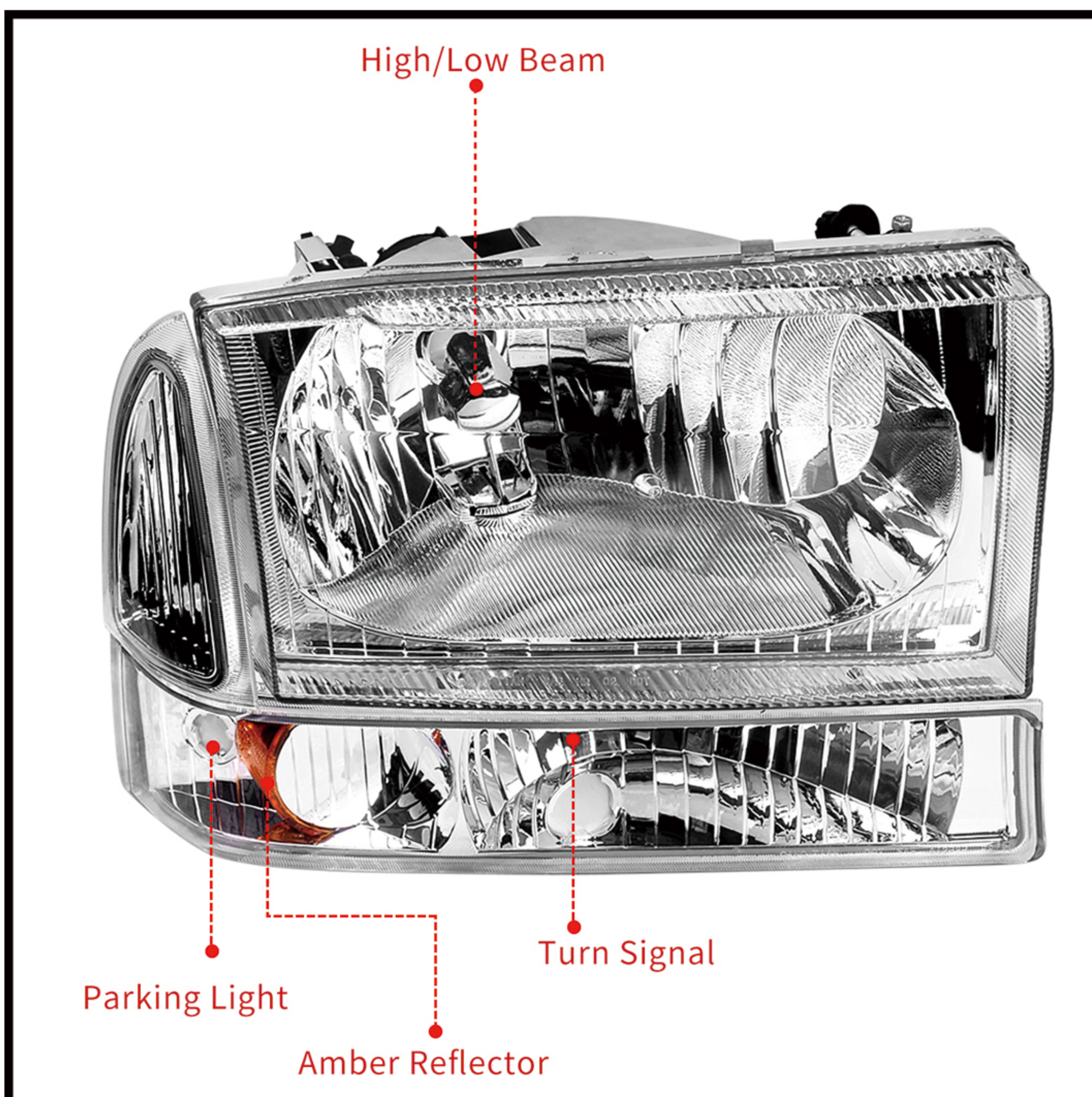

Before you begin to adjust the light, make sure check the alignment of your lights first. Park the vehicle about 10 to 25 feet from the wall with the lights aimed at the wall. The centerlines of the headlights should not be any higher than 3.5 feet above the ground.

---

1. Find the adjustment screws.
2. Adjust the headlights individually.
3. Adjust the vertical field.
4. Test your results.